

INTERIOR DESIGN WORK DETAIL SPECIFICATIONS

1. Flooring works



CARPET TILE

Quantity: As per BoQ
Company: Hego or equivalent
Product specification: *EN 3452 CARBON*
Construction: Tufted Level Loop
Material: 100% P.P B.C. F (UV Treated)
Pile Weight: 580 Gr/ M2 +/- 5%
Pile Height: 4 mm
Primary Backing: Non-Woven
Secondary Backing: Bitumen Backing
Size: 50cm x 50cm (2ft. x 2ft.)

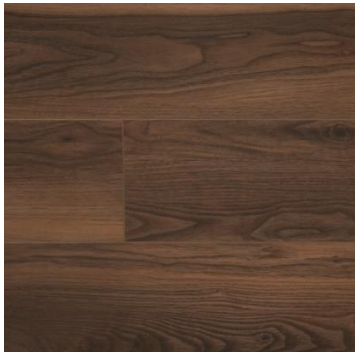

FLOOR LAMINATE

Quantity: As per BoQ
Company: Natural Rain Forest or equivalent
Product specification: **Walnut flooring**
Grade: AC4
Thickness: 8mm



WALL PAINT:

Quantity: As per BoQ
Company: Berger or equivalent
Product specification: On walls
Product Description: Grey & White paint

2. Wall & Ceiling works



WALL TILE:

Quantity: As per BoQ

Company: Simpolo Tiles or equivalent

Product specification: Dune River Grey

Product Description: Size: 598x598mm

Thickness: 9mm

Finish: Dune



STAND ALONE WPC LUVERS:

Quantity: As per BoQ

Company: Jinbao or equivalent

Product specification: White- and walnut-coloured finishes

Product Description: Size: free size

Thickness: 24mm

Finish: White- and walnut-coloured finishes

3. Acoustic Panel works



WALL ACOUSTIC PANEL:

Quantity: As per BoQ

Company: TAP Panels or equivalent

Product specification: Natural Beige

Product Description: Size: 600x600 and 8ft x 4ft

Thickness: 9mm

Composition: 100% Polyester Fiber (PET)

4. Other works



THEATER/ LECTURE SEATS:

Quantity: As per BoQ

Company: N/A China

Product specification: Fold-able seat with writing table

Product Description:

- Fabric: Grey
- Other components: Wooden and Black

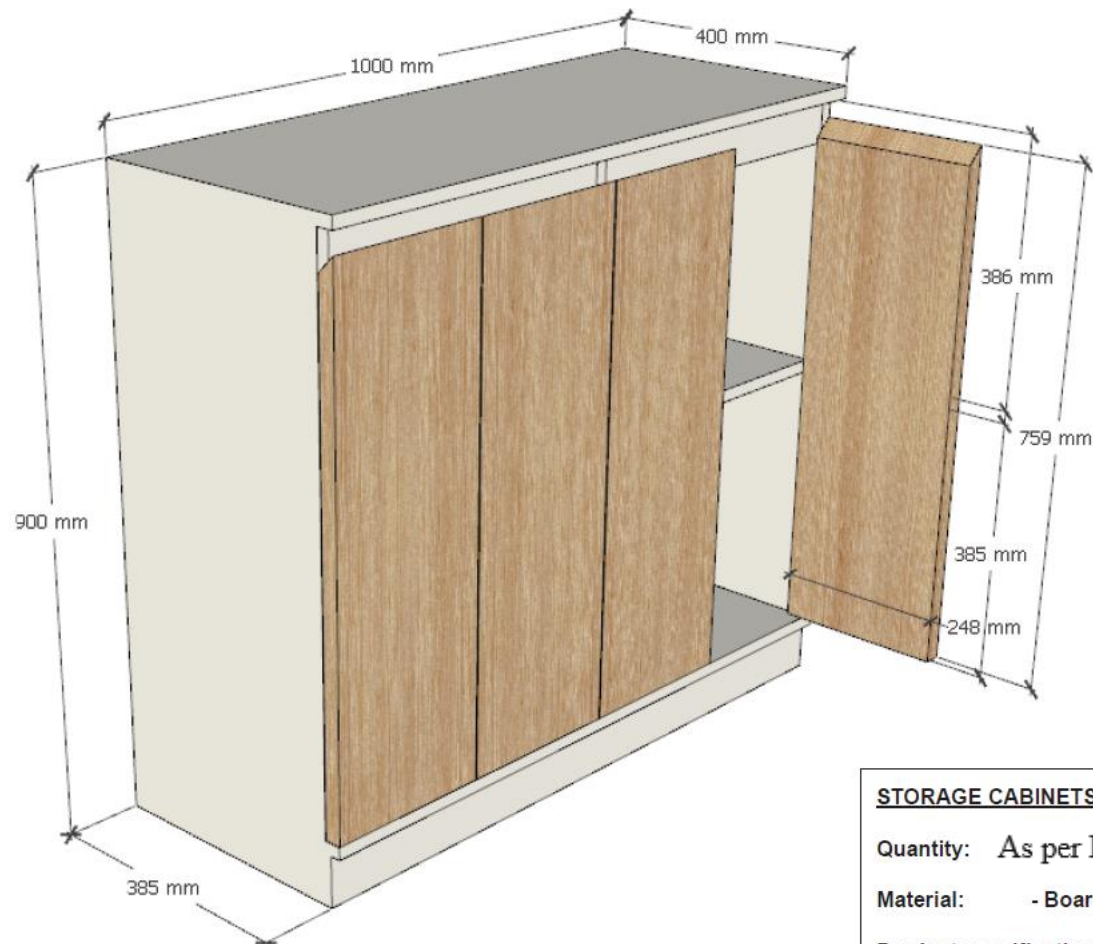

STORAGE CABINETS

Quantity: As per BoQ

Material: - Board with laminate

Product specification:

Company: KALN or equivalent
Model / series: Houke Series



BLACK OUT ROLLER BLINDS:

Quantity: _____

As per BoQ

**Including Motors and single remote control for blinds*

Company: Livin Blinds or equivalent

Product Description:

- Black out blinds
- Motorized blinds



RECESSED LIGHT:

Quantity: As per BoQ

Company: Jaquar or equivalent

Product specification: COB-DOWNLIGHTS

Item detail: Ares Focus Light - IP54

LARS01R013XW

Size: Cutout: 70mm diameter

Height: 48mm

Wattage: 13w

CCT: 3000k

5. Sign Board works

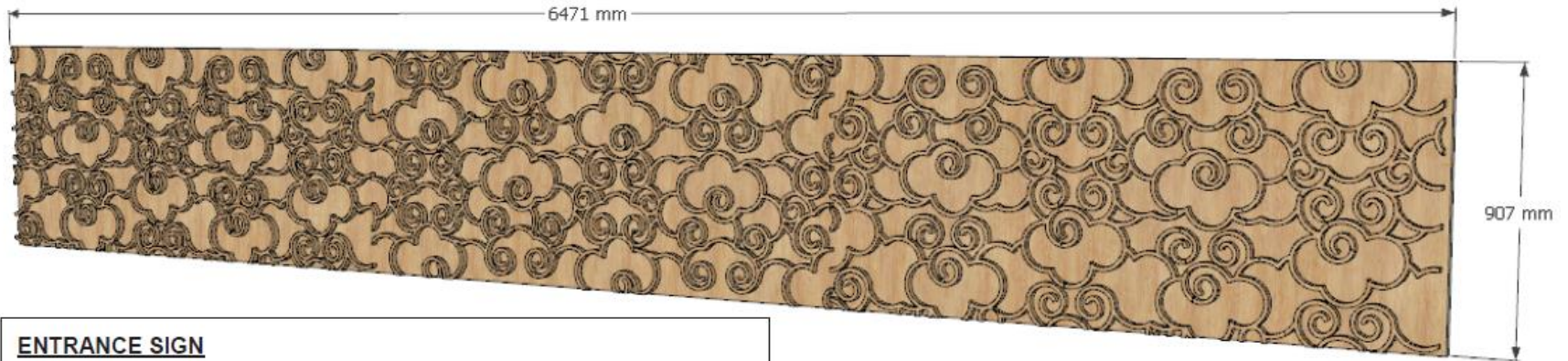

ENTRANCE SIGN

Quantity: As per BoQ

Material:

- Hemlock Wood

-12mm / 8mm MDF

- Melamine:

Company: Asian Paints / Nerolac / Woodver

Item detail: Matt finish

Note:

-Engraved with cloud motifs. Length might change depending on site condition (spans the length of the beam at the entrance).

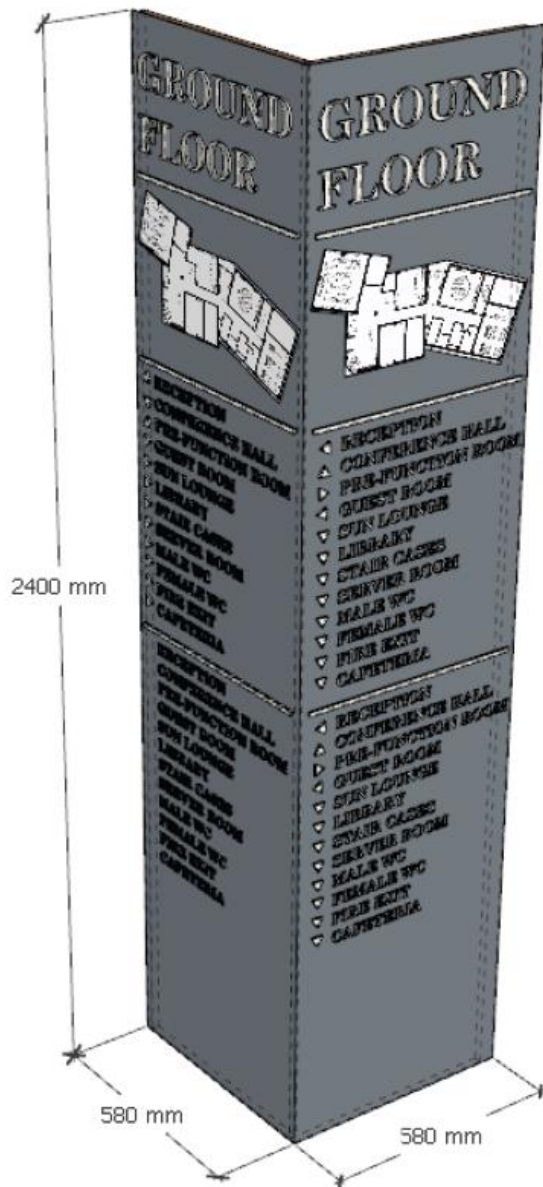

CORNER SIGN

Quantity: As per BoQ

Material: - 12mm Ply backing
- ACP

Product specification:

-ACP

Company: Pratap Bond or equivalent

Item detail: PB 02 (Metallic Silver)

Note:

-All text must be finalized before printing.

-White UV print

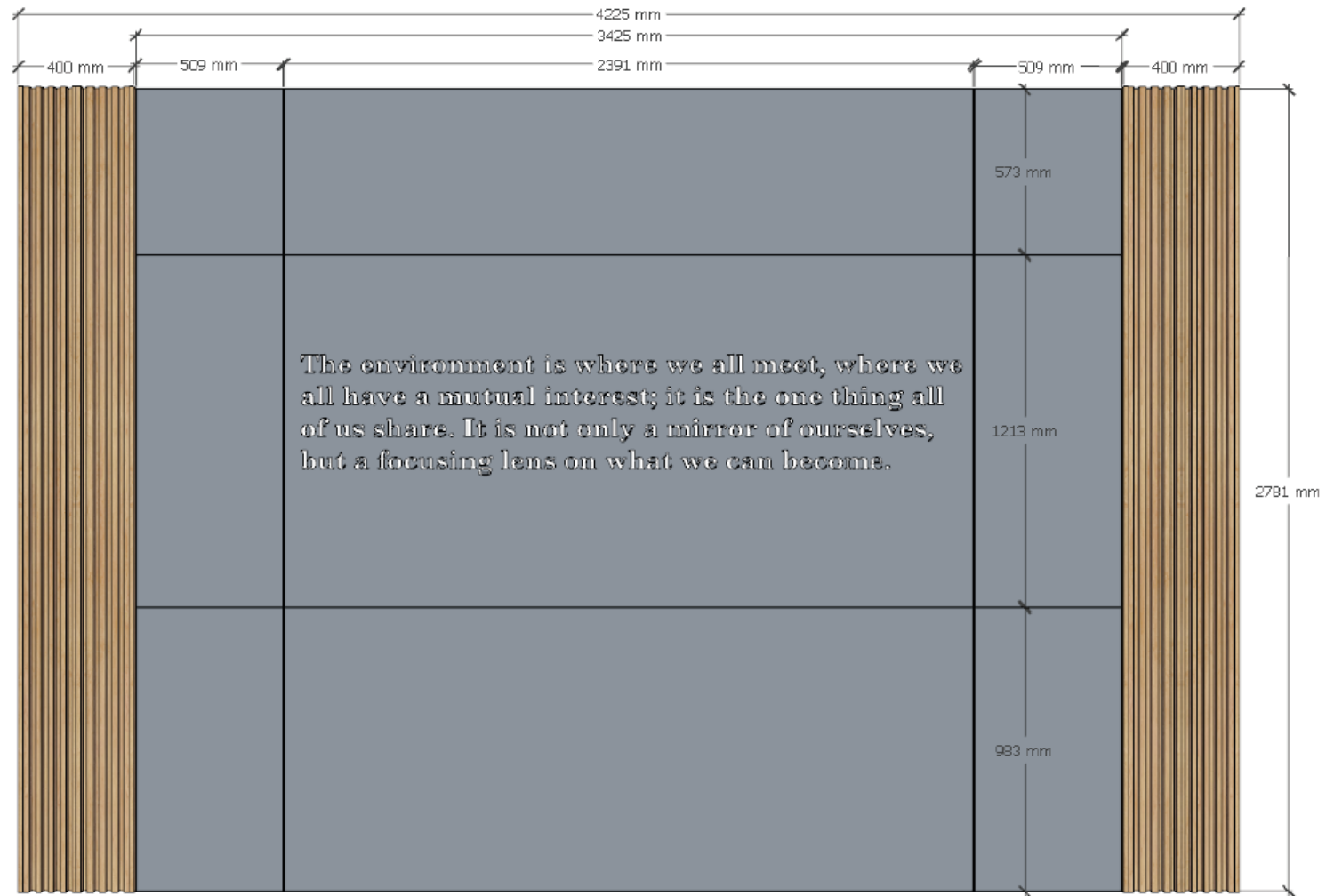

TEXT WALL

Quantity: As per BoQ

Materials:
- 12mm Ply backing

-ACP

Company: Pratap Bond or equivalent
Item detail: PB 02 (Metallic Silver)

-WPC Louvers in Oak

Note:

-All text must be finalized before printing.
-White UV print

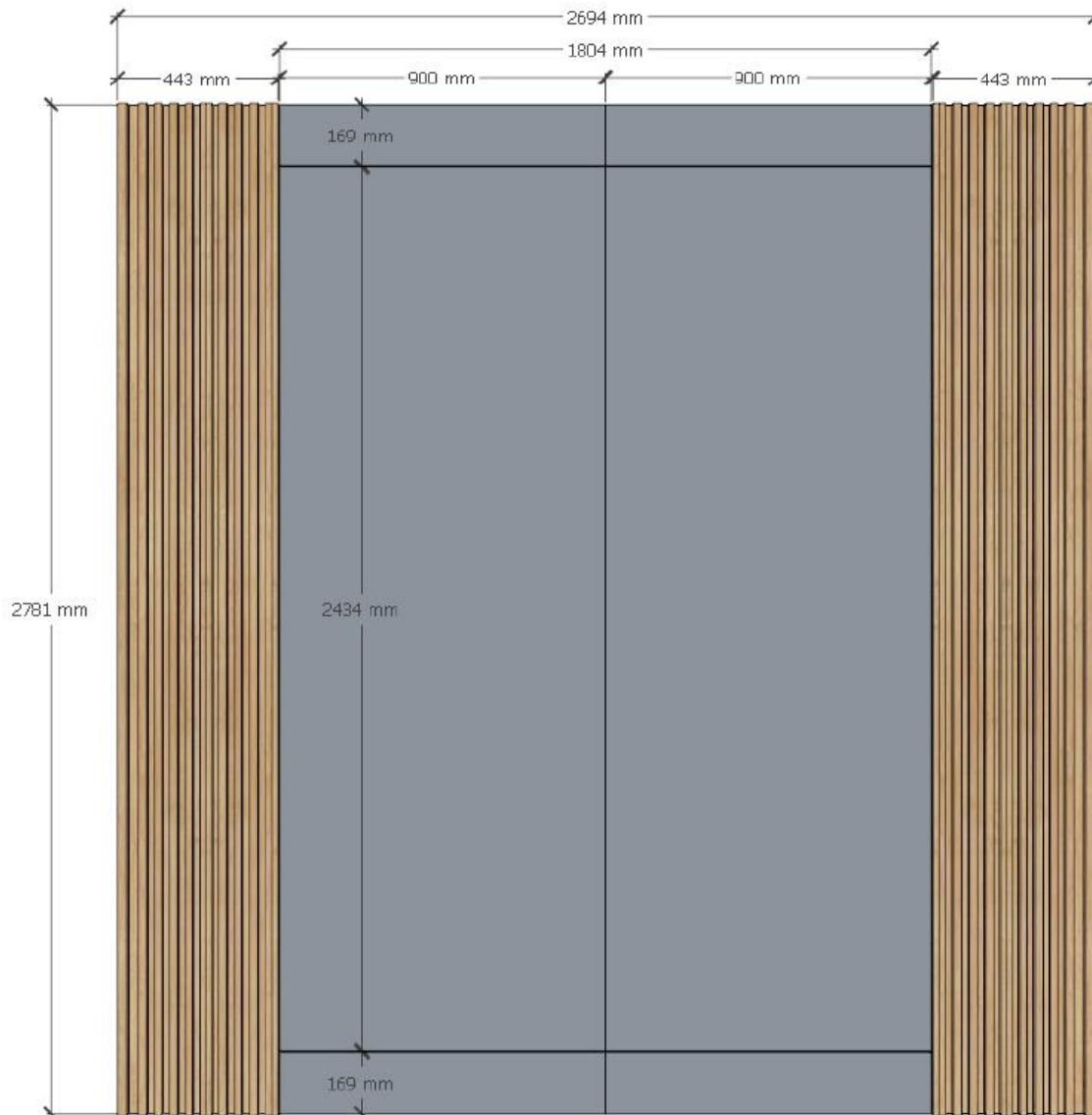

ACP WALL

Quantity: As per BoQ

Material:

- 12mm Ply backing

- ACP

Company: Pratap Bond or equivalent
Item detail: PB 02 (Metallic Silver)

- WPC Louvers in Oak

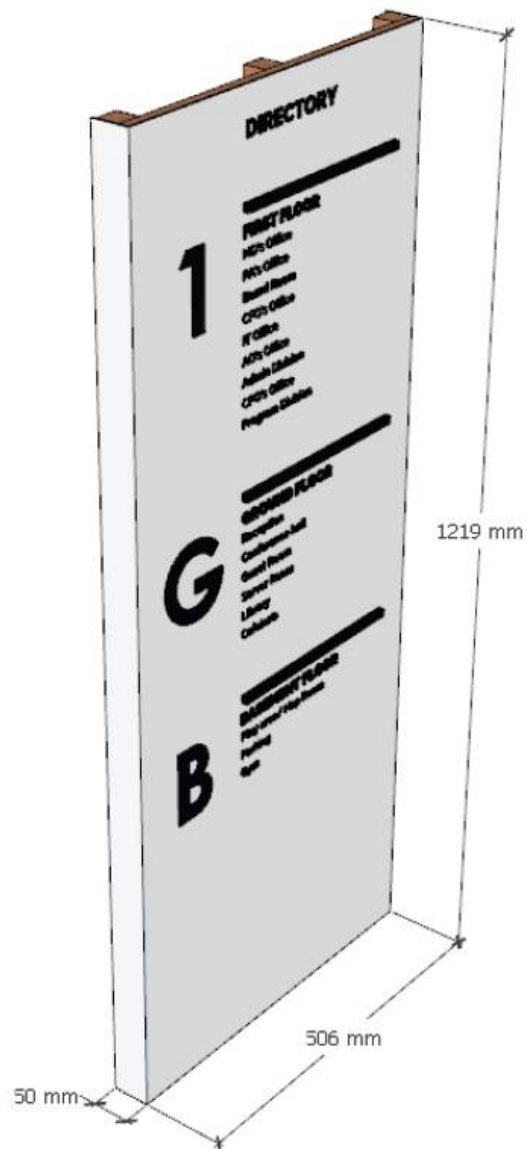

CORNER SIGN

Quantity: As per BoQ

Material: - 12mm Ply backing
 - Wooden backing support (Hemlock)
 - ACP

Product specification:

-ACP

Company: Pratap Bond or equivalent

Item detail: PB 18 (Pure White)

Note:

-All text must be finalized before printing.

-Black UV print

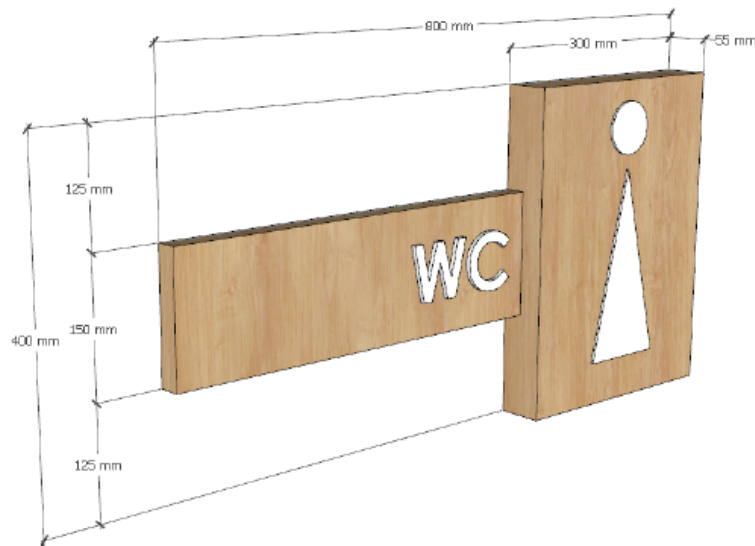

WC SIGN

Quantity: As per BoQ

Material:

- Hemlock wood

- Melamine:

Company: Asian Paints / Nerolac / Woodver
Item detail: Matt finish

Note:

- All text must be finalized before printing.
- White UV print

ROOM SIGN IN ACP

Quantity: As per BoQ

Material:

- 12mm Ply backing

- ACP

Product specification:

-ACP

Company: Pratap Bond or equivalent
Item detail: PB 02 (Metallic Silver)

Note:

- All text must be finalized before printing.
- White UV print

6. Furniture works

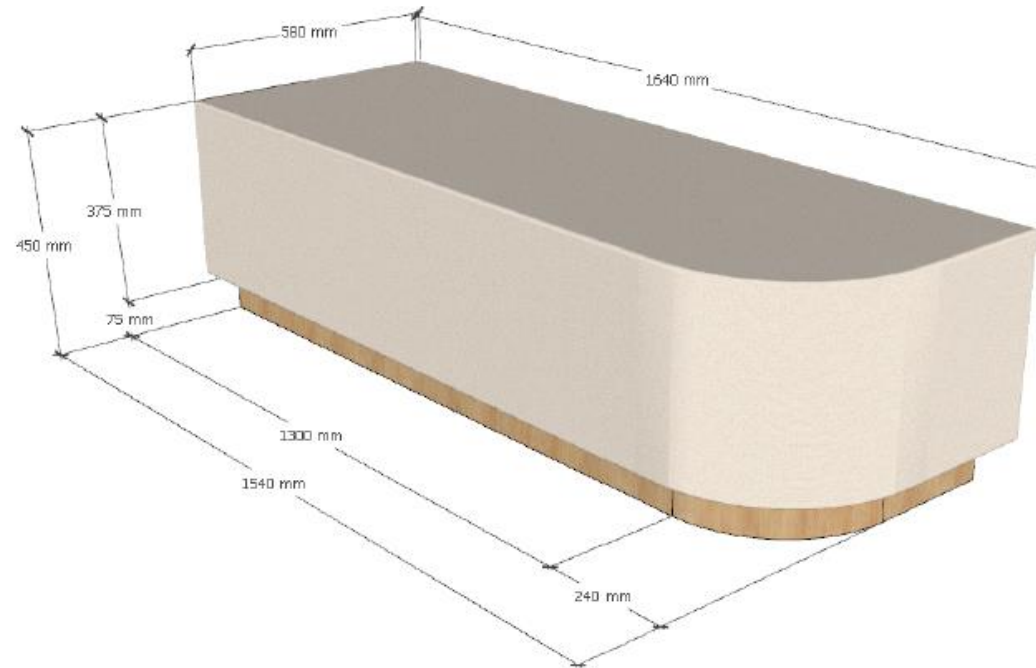

COUNTER DEEWANS

Quantity: As per BoQ

Materials:

- 12mm Ply

- Hemlock wood

- Melamine:

Company: Asian Paints / Nerolac / Woodver
Item detail: Matt finish

- Foam:

- Company: Bindal
- Item detail: 32 and 23 densities

- Fabric:

- Company: V & J Furnishing or equivalent
- Item detail: Collection: Brizzo



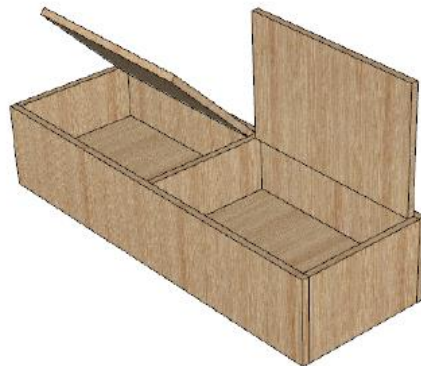
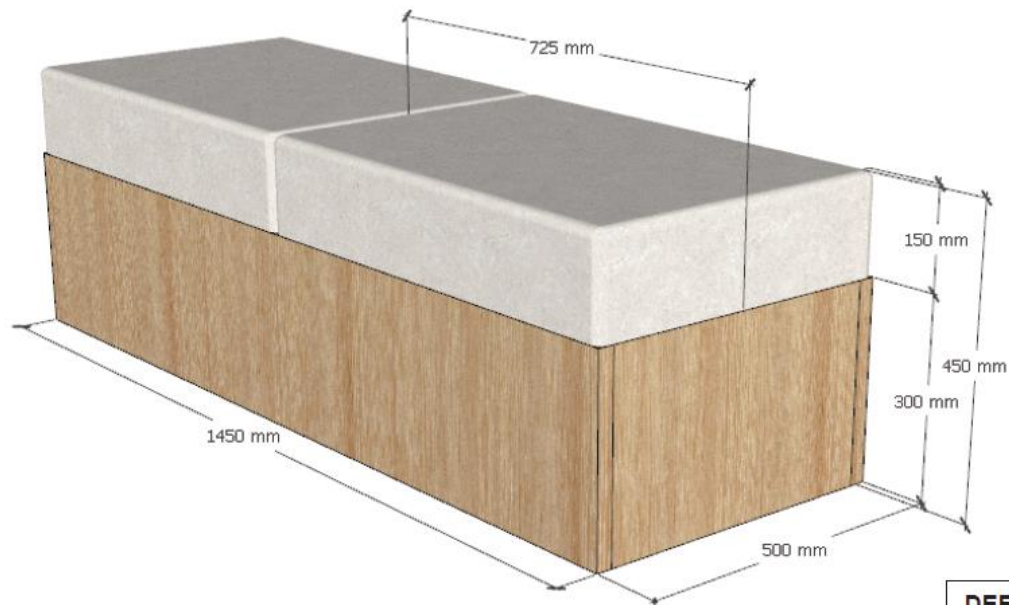

DEEWAN WITH STORAGE

Quantity: As per BoQ

Materials:

- 12mm Ply

- Hemlock wood

- Melamine:

Company: Asian Paints / Nerolac / Woodver

Item detail: Matt finish

- Foam:

- Company: Bindal

- Item detail: 32 and 23 densities

- Fabric:

- Company: V & J Furnishing or equivalent

- Item detail: Collection: Curve

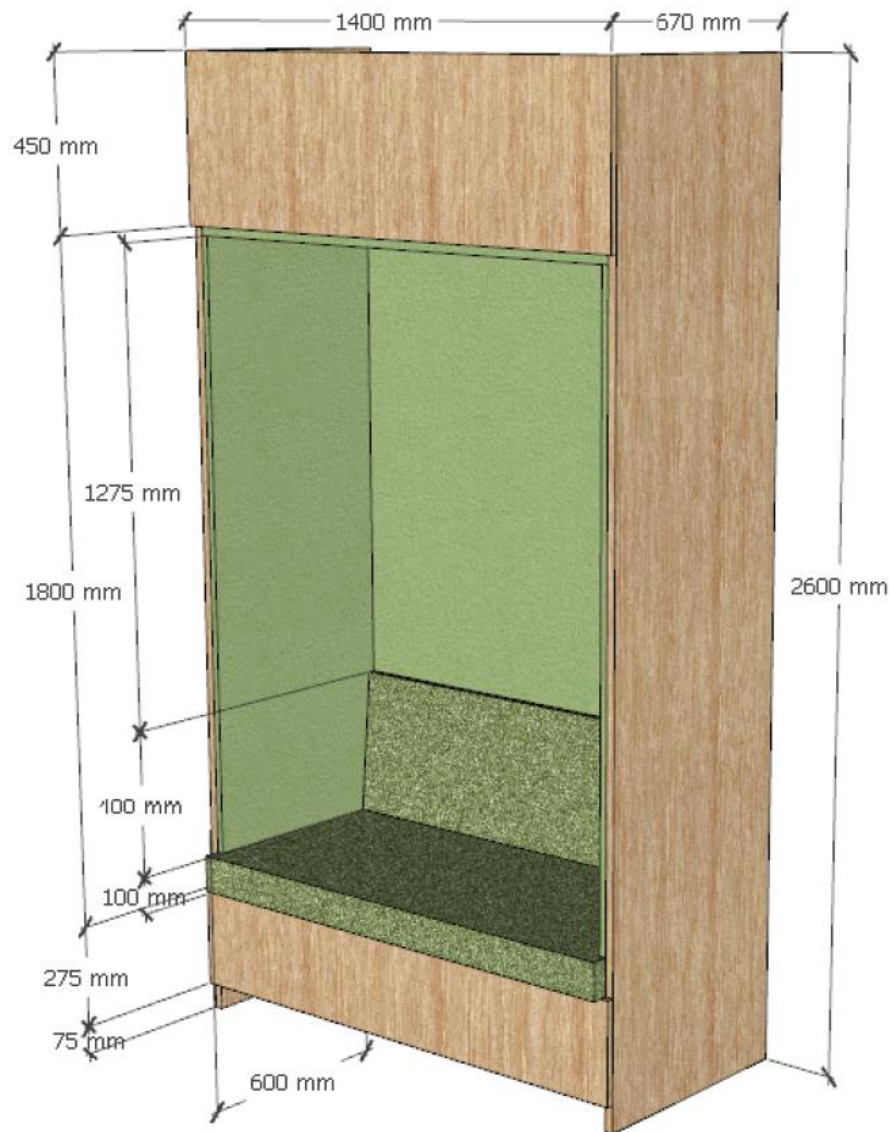

LIBRARY SOLO SEATS

Quantity: As per BoQ

Material:

- **Acoustic foam:**
Company: TAP Panels
Item detail: Grass Green (plain)

- **12mm Ply board**

- **Hemlock Wood**

- **Melamine:**
Company: Asian Paints / Nerolac
/ Woodver

Item detail: Matt finish

- **Foam:**

- Company: Bindal
- Item detail: 32 and 23 densities

- **Fabric:**

- Company: V & J Furnishing or equivalent
- Item detail: Collection: Lampas



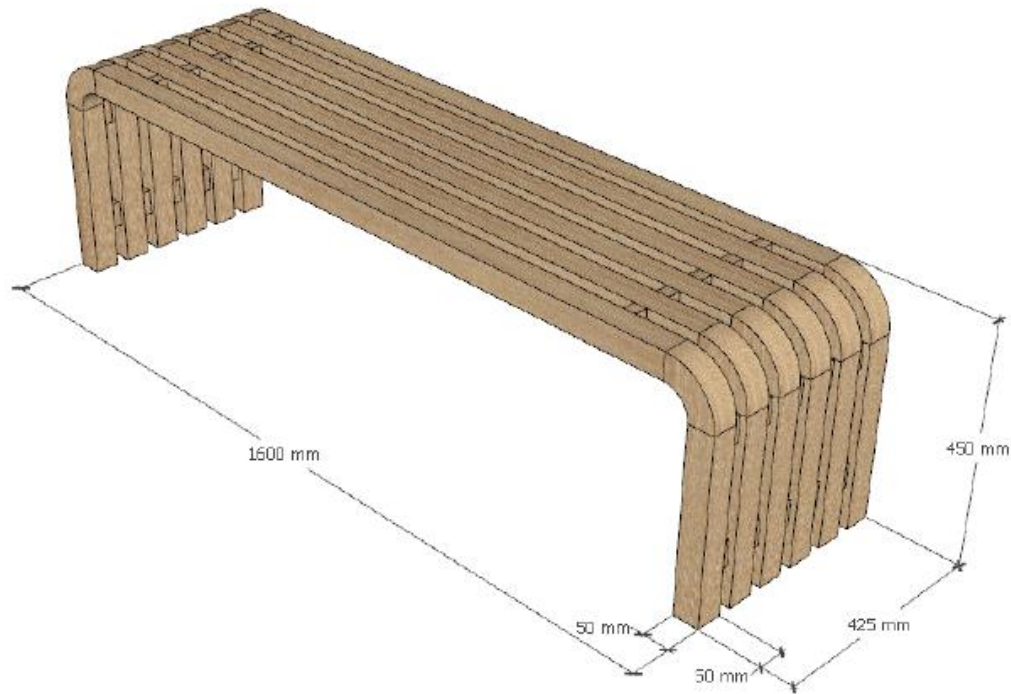

CURVED BENCH:

Quantity: As per BoQ

Materials:

- Hemlock wood

- Melamine:

Company: Asian Paints / Nerolac / Woodver
Item detail: Matt finish

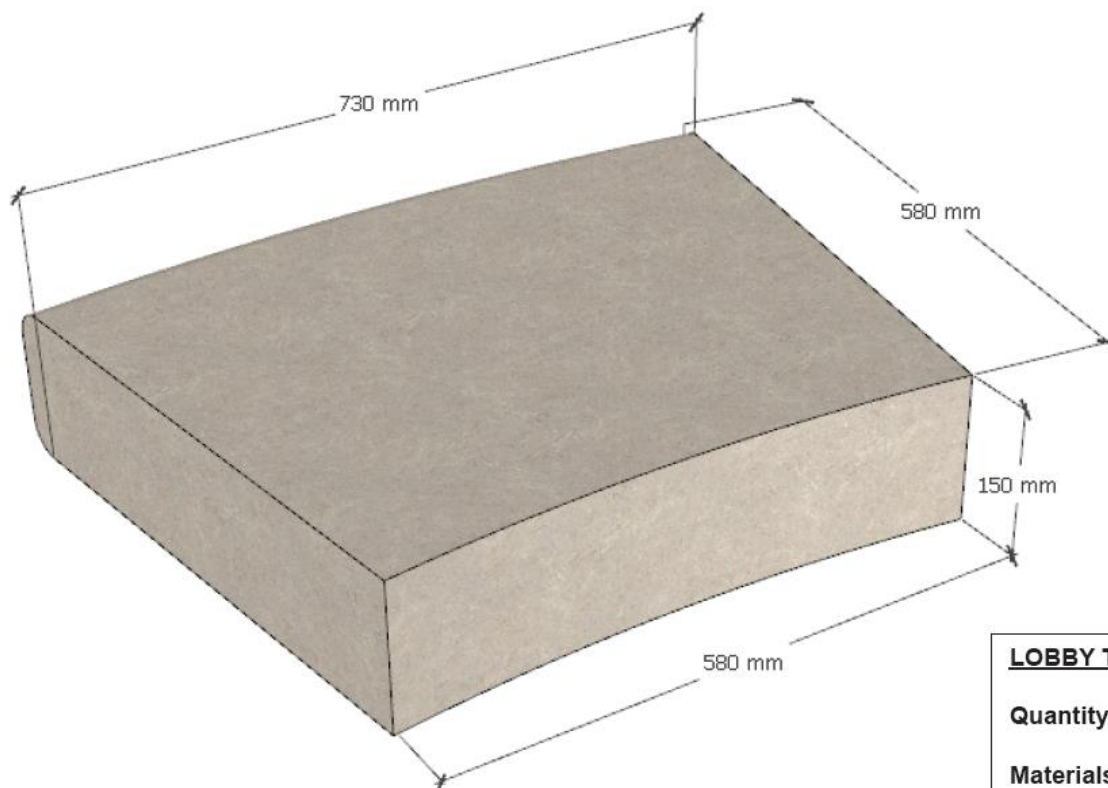

LOBBY TREE BASE CUSHION

Quantity: As per BoQ

Materials:

- 12mm Ply

- **Foam:**

- Company: Bindal
- Item detail: 32 and 23 densities

- **Fabric:**

- Company: D'decor or equivalent
- Item detail: Beige color, waterproof



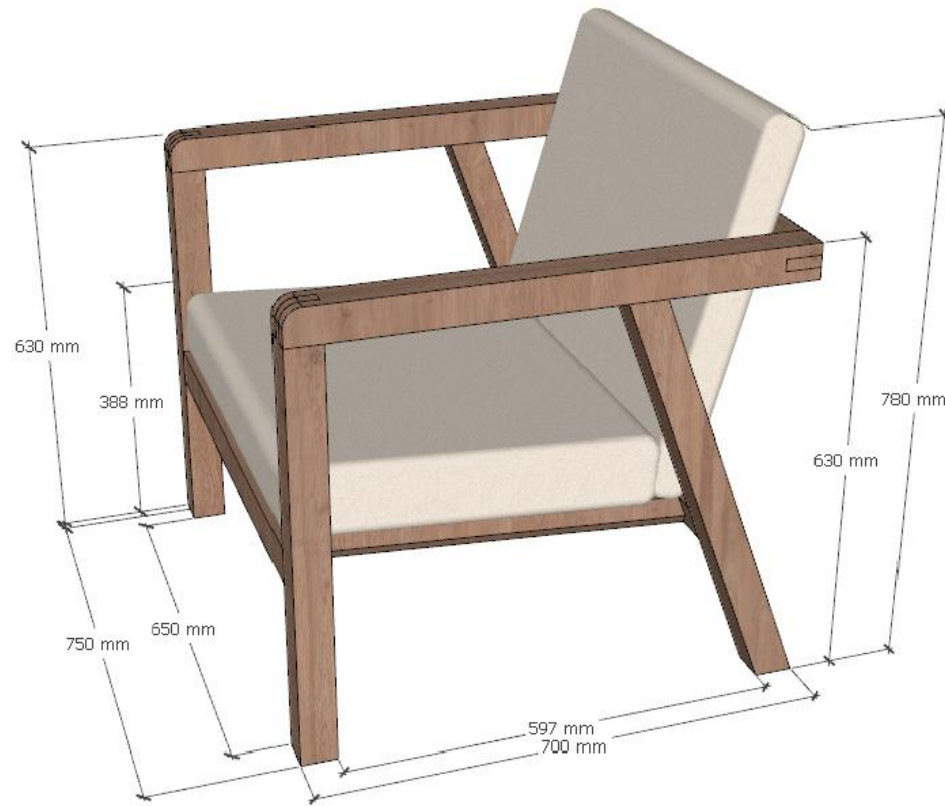

LOBBY SINGLE SEATER

Quantity: As per BoQ

Materials:

- 12mm Ply

- Hemlock wood

- Stain:

Company: Charm wood or equivalent
Item detail: Walnut in Matt finish

- Foam:

- Company: Bindal or equivalent
- Item detail: 32 and 23 densities

- Fabric:

- Company: V & J Furnishing or equivalent
- Item detail: Collection: Curve



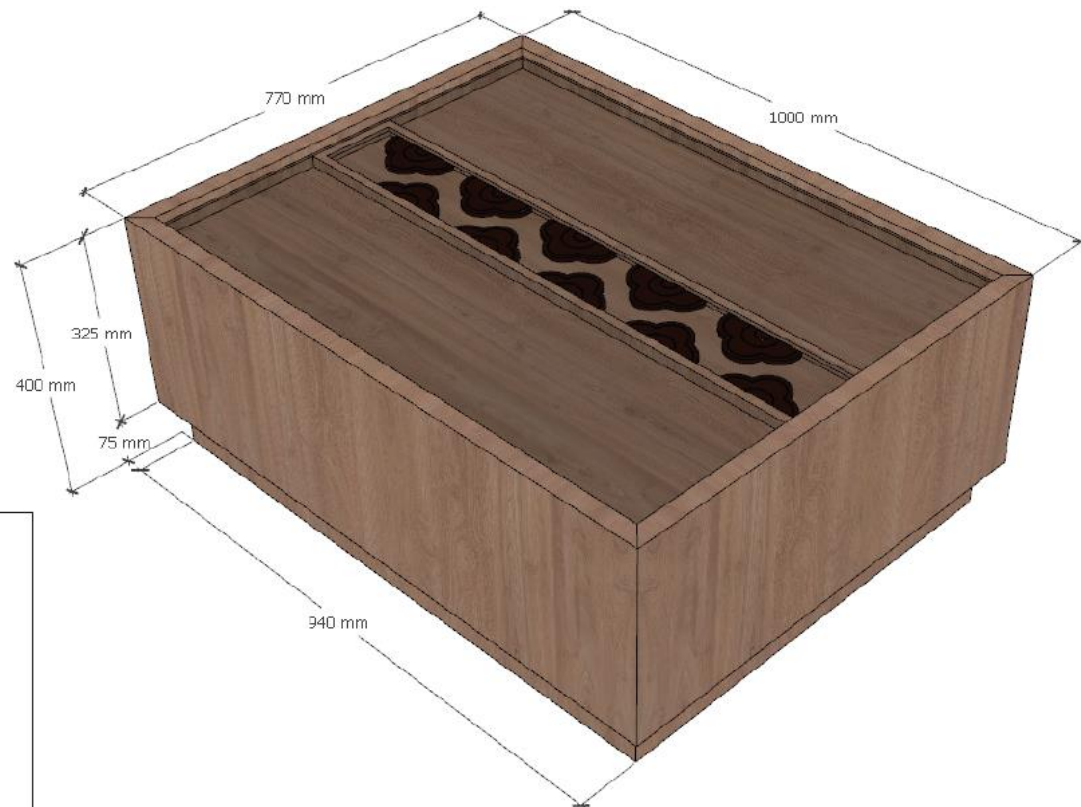

GLASS TABLE

Quantity: As per BoQ

Material:

- Glass
- Hemlock Wood
- 12mm / 8mm MDF
- Stain:

Company: Charm wood or equivalent
Item detail: Walnut in Matt finish

Note:

-Engraved with cloud motifs.

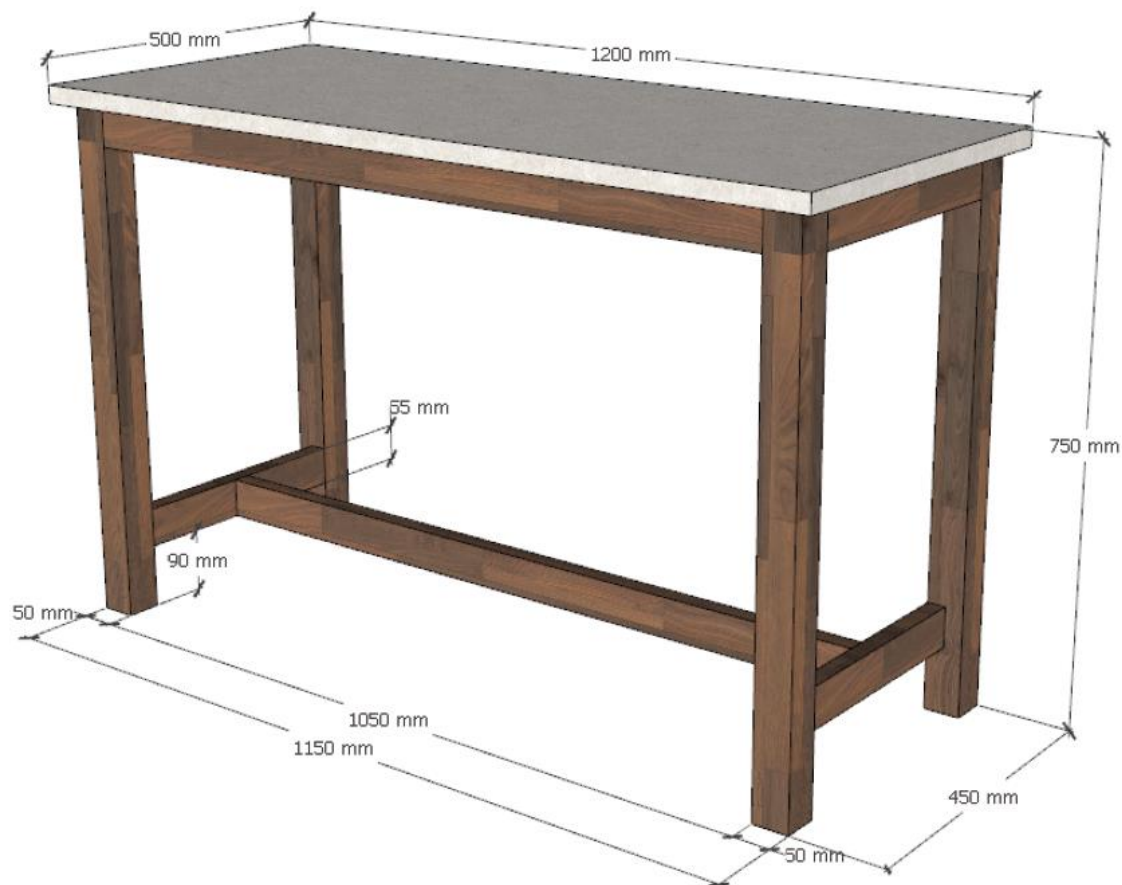

SOLID SURFACE TOPPED TABLE

Quantity: As per BoQ

Material:

- **Solid Surface:**
 - Company: Evo Surfaces or equivalent
 - Item detail: White speckled
- **Hemlock Wood**
- **Stain:**
 - Company: Charm wood or equivalent
 - Item detail: Walnut in Matt finish
- **18mm Ply support**



ENGRAVED LARGE PHOTO FRAME

Quantity: As per BoQ

Material:

- Rubber Wood
- Stain:
Company: Charm wood or equivalent
Item detail: Walnut in Matt finish
- Glass
- MDF backing
- Paper mount

Note:

- 3D engraved borders

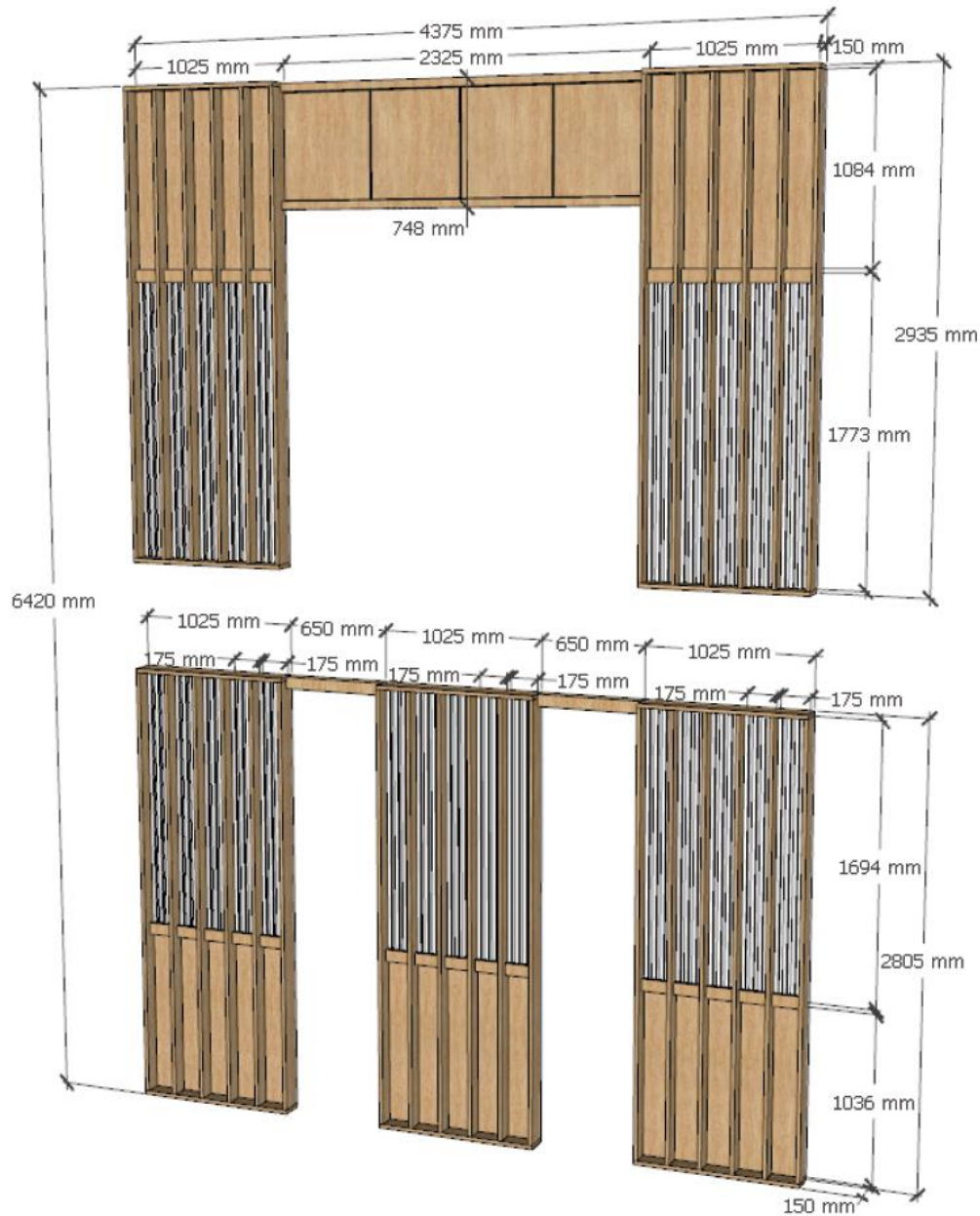

ENTRANCE WALL

Quantity: As per BoQ

Material:

- WPC Louvers in White

- Hemlock Wood

-12mm Ply

-Melamine:

Company: Asian Paints / Nerolac /
Woodver

Item detail: Matt finish

-Veneer:

Company: Canvas Ply or equivalent
Item detail: White Oak

-LED Light with profile:

Company: Speed or equivalent
Item detail: 12w

-LED Light driver:

Company: Speed or equivalent
Item detail: 5Amp





CONFERENCE ENTRANCE

Quantity: As per BoQ

Material:

- Acoustic foam:

Company: TAP Panels or equivalent
Item detail: Light Beige (plain and engraved)

- Hemlock Wood

-12mm Ply

- Melamine:

Company: Asian Paints / Nerolac / Woodver
Item detail: Matt finish

-Veneer:

Company: Canvas Ply or equivalent
Item detail: White Oak

-LED Light with profile:

Company: Speed or equivalent
Item detail: 12w

-LED Light driver:

Company: Speed or equivalent
Item detail: 5Amp



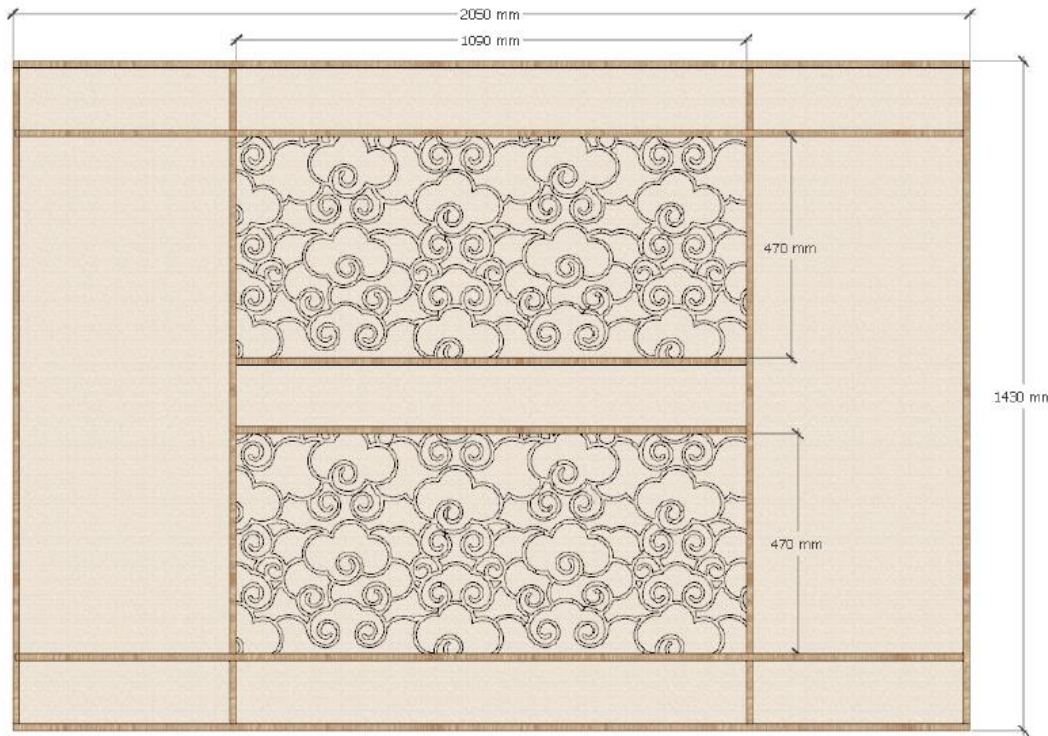

ACOUSTIC WALL DESIGN 1 & 2

Quantity: As per BoQ

Material:

- Acoustic foam:

Company: TAP Panels or equivalent
Item detail: Light Beige (plain and engraved)

- Hemlock Wood

-Melamine:

Company: Asian Paints / Nerolac / Woodver
Item detail: Matt finish

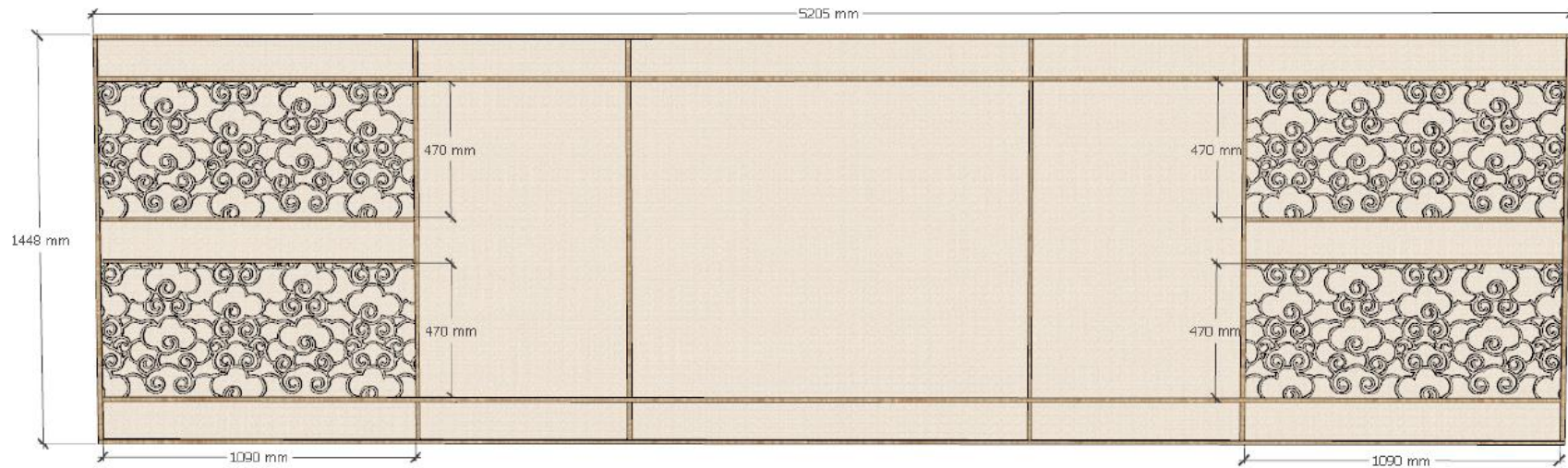

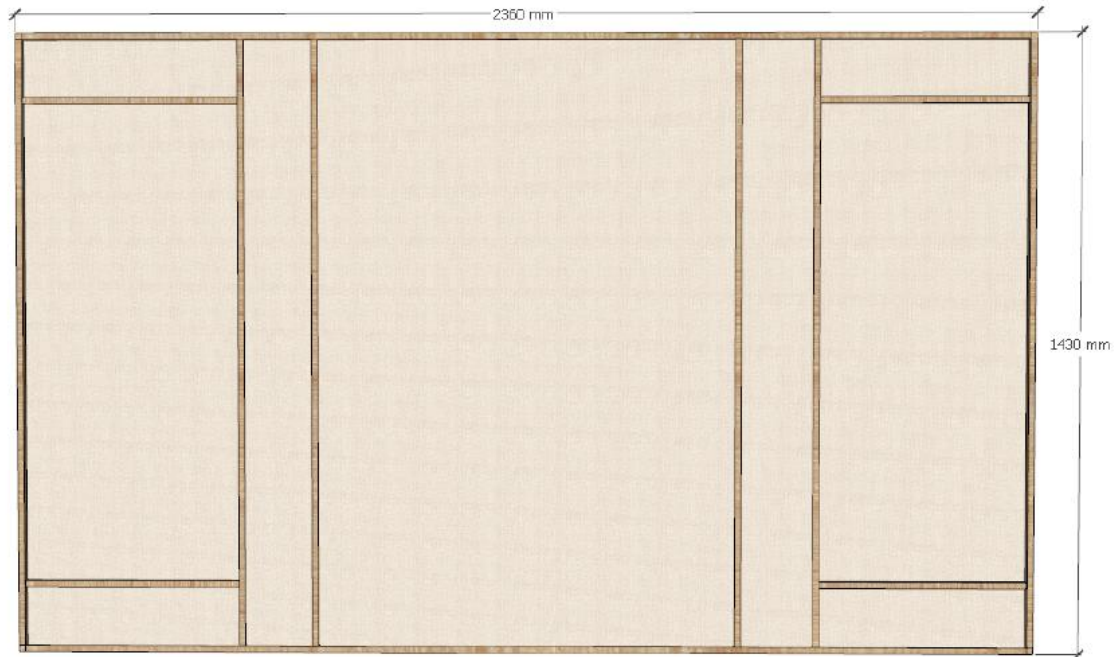

ACOUSTIC WALL DESIGN 3

Quantity: As per BoQ

Material:

- Acoustic foam:

Company: TAP Panels or equivalent
Item detail: Light Beige (plain
and engraved)

- Hemlock Wood

-Melamine:

Company: Asian Paints / Nerolac
/ Woodver
Item detail: Matt finish

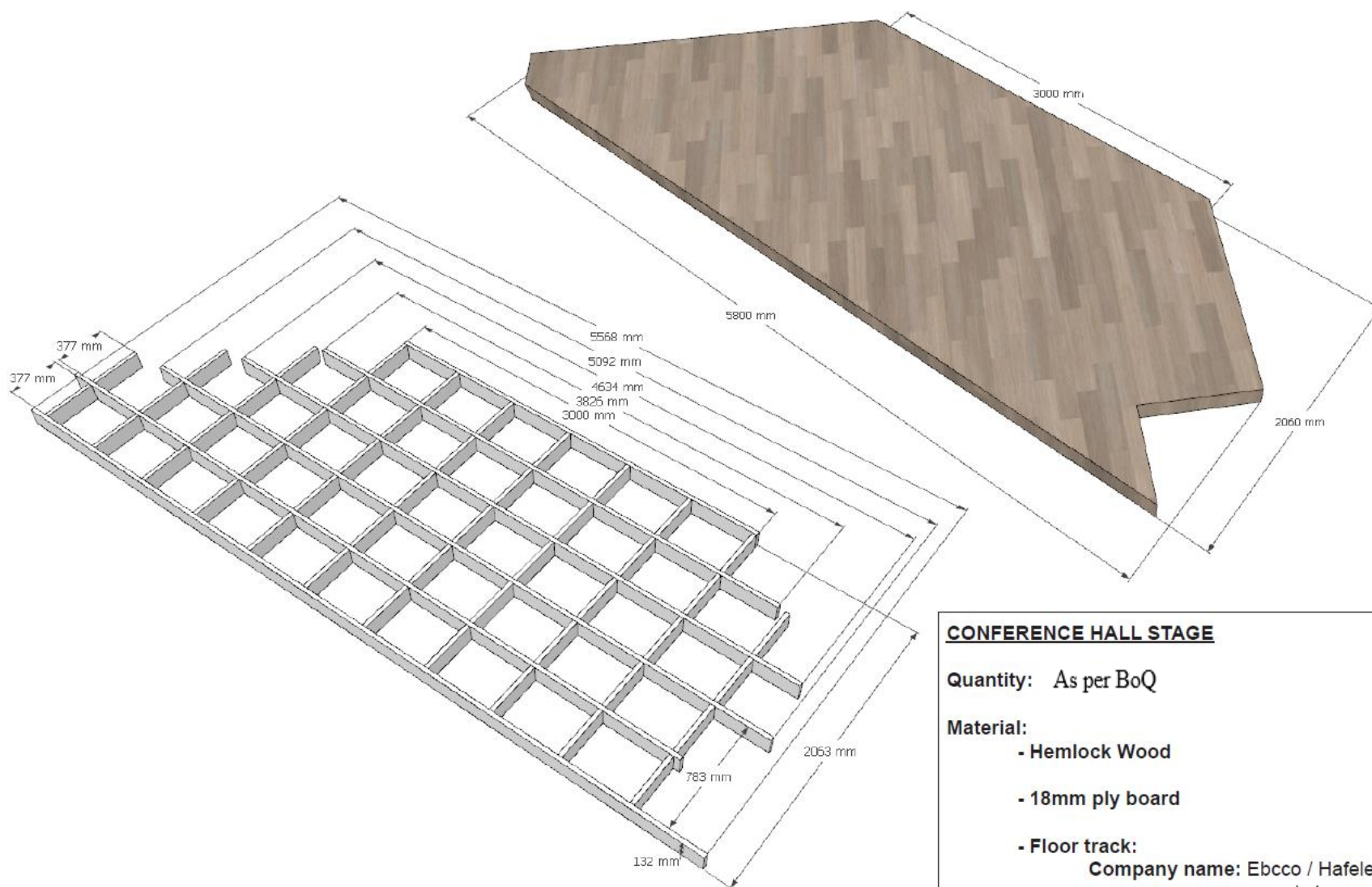

CONFERENCE HALL STAGE

Quantity: As per BoQ

Material:

- Hemlock Wood
- 18mm ply board
- Floor track:

Company name: Ebcco / Hafele
or equivalent

**Flooring priced separately*

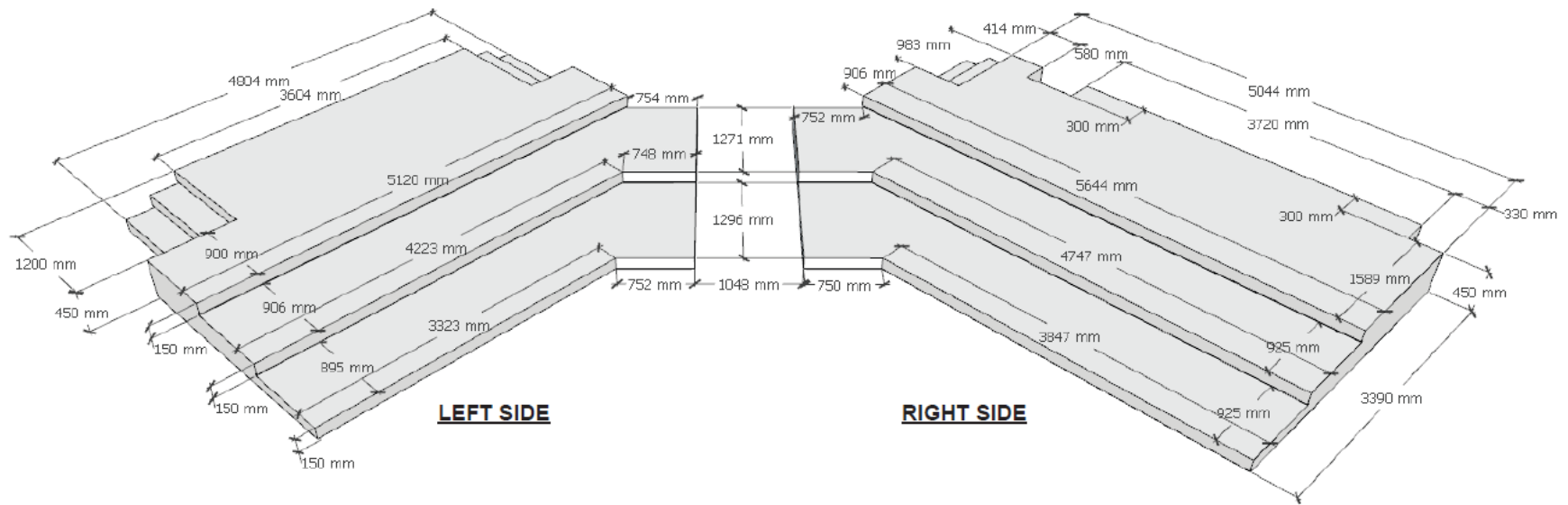

SEATING AREA

Quantity: As per BoQ

Material:

- Steel (30x30mm / 40x40mm)

- 18mm ply board

**Carpet priced separately sizes might change depending on site condition*

**Does not include any electrical works*

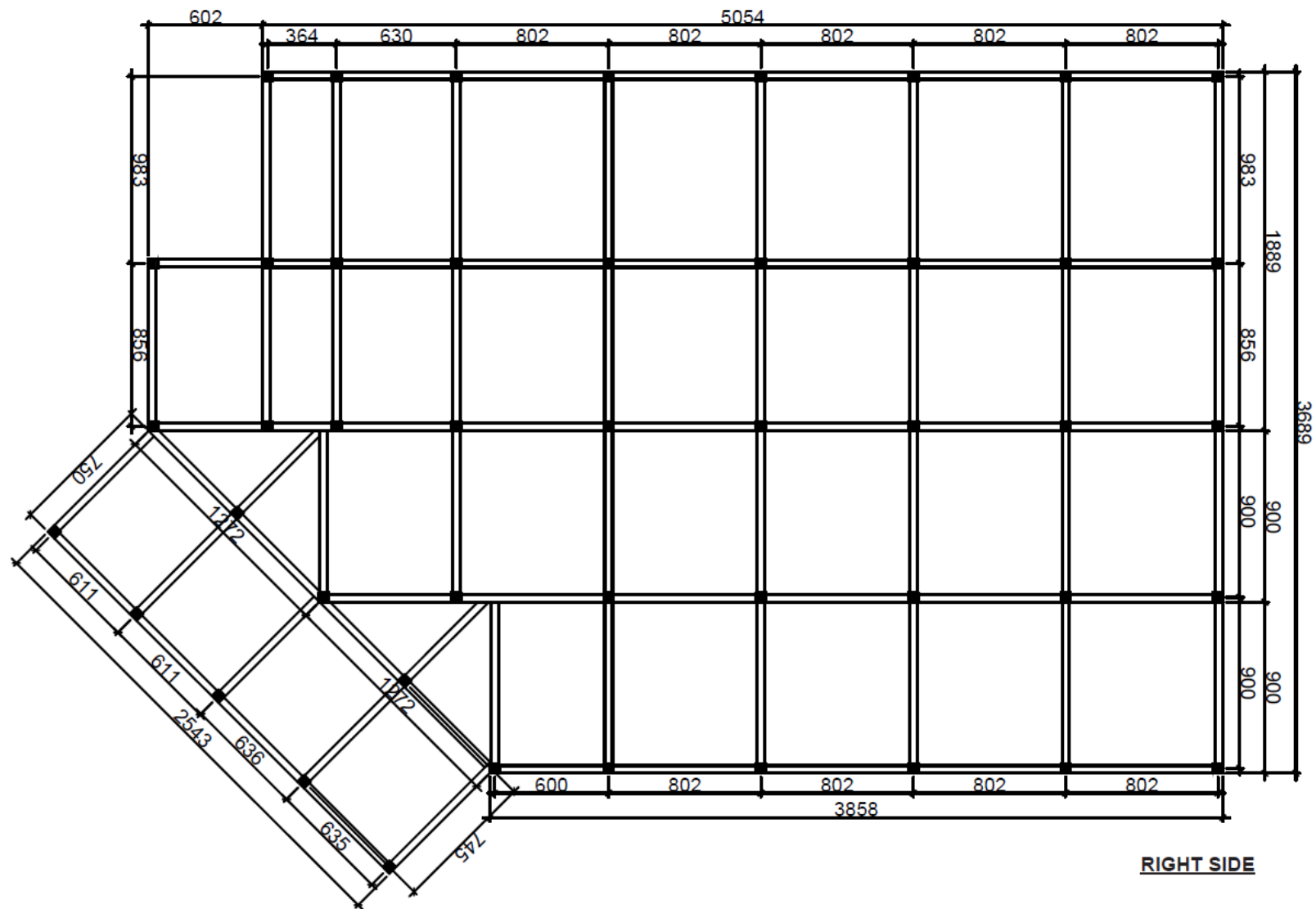

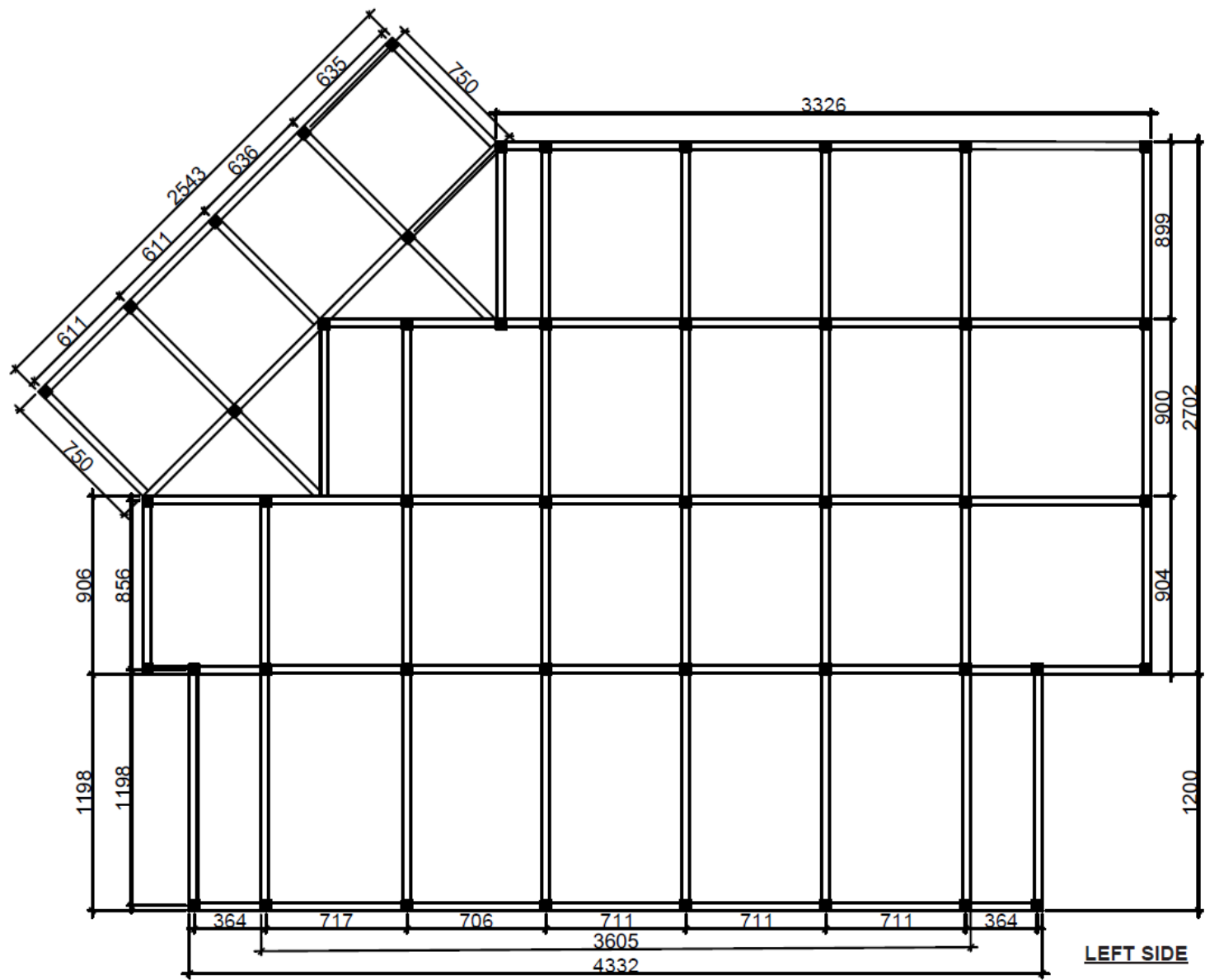

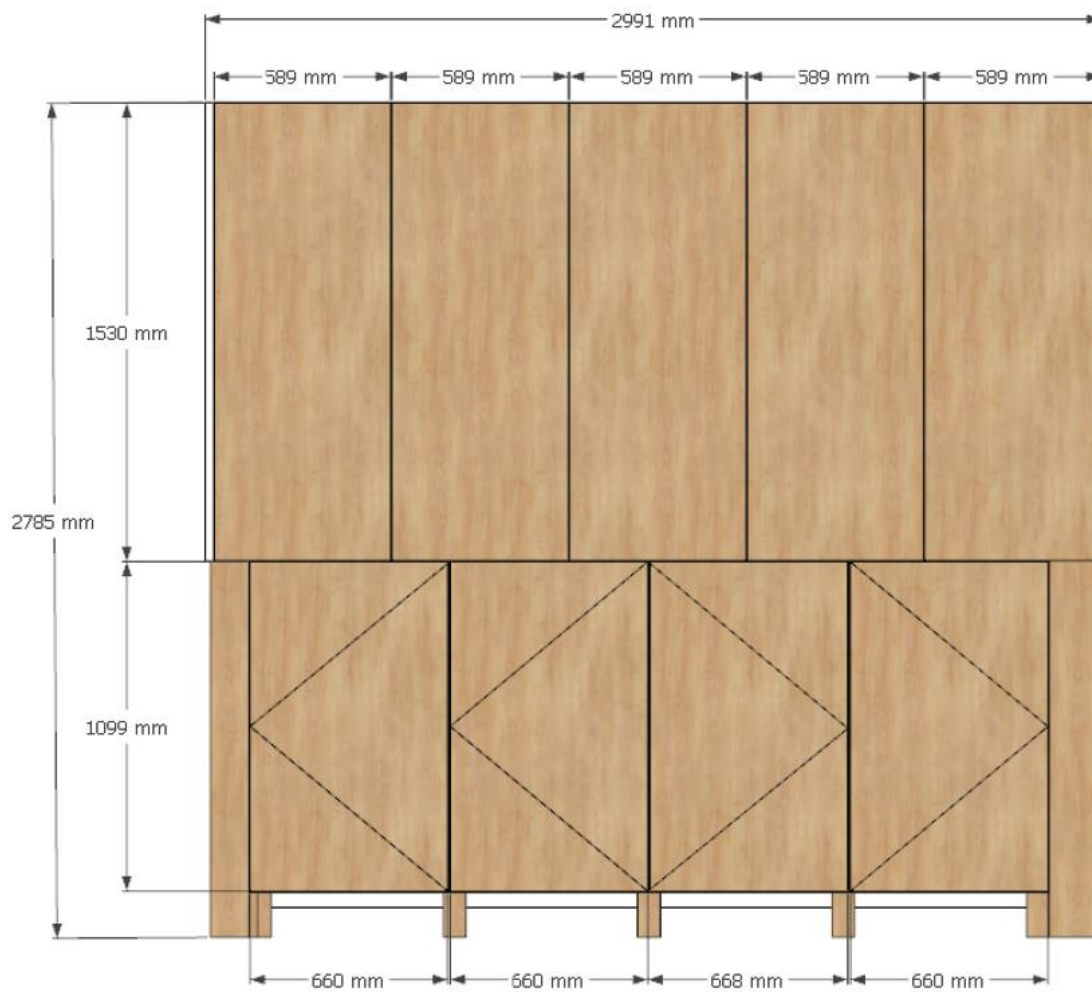

PARTITION WALL

Quantity: As per BoQ

Material:

- Hemlock Wood

-12mm Ply

- Melamine:

Company: Asian Paints /
Nerolac / Woodver
Item detail: Matt finish

-Veneer:

Company: Canvas Ply or equivalent
Item detail: White Oak

Hardware:

- Hinge:

-Company: Laranza or equivalent
-Item detail: 0 degree hinge

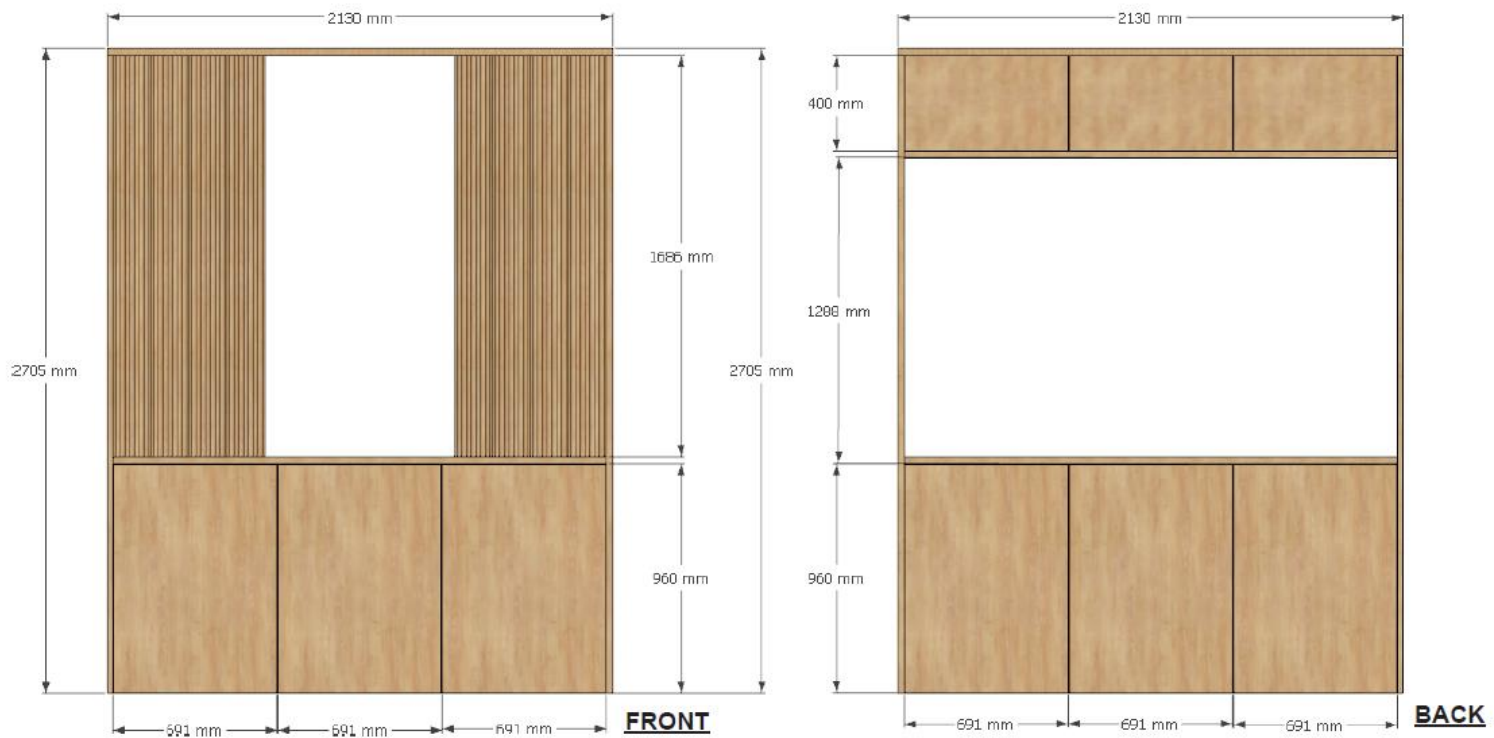

ENTRANCE PARTITION WALL

Quantity: As per BoQ

Material:
- 12mm Ply

- Hemlock Wood

- Melamine:
Company: Asian Paints / Nerolac / Woodver
Item detail: Matt finish

-Veneer:
Company: Canvas Ply or equivalent
Item detail: White Oak

- Gypsum board

- Paint:
Company: Berger
Item detail: Rangoli White

- WPC Louvers in Oak

-LED Light with profile:
Company: Speed or equivalent
Item detail: 12w

-LED Light driver:
Company: Speed or equivalent
Item detail: 5Amp



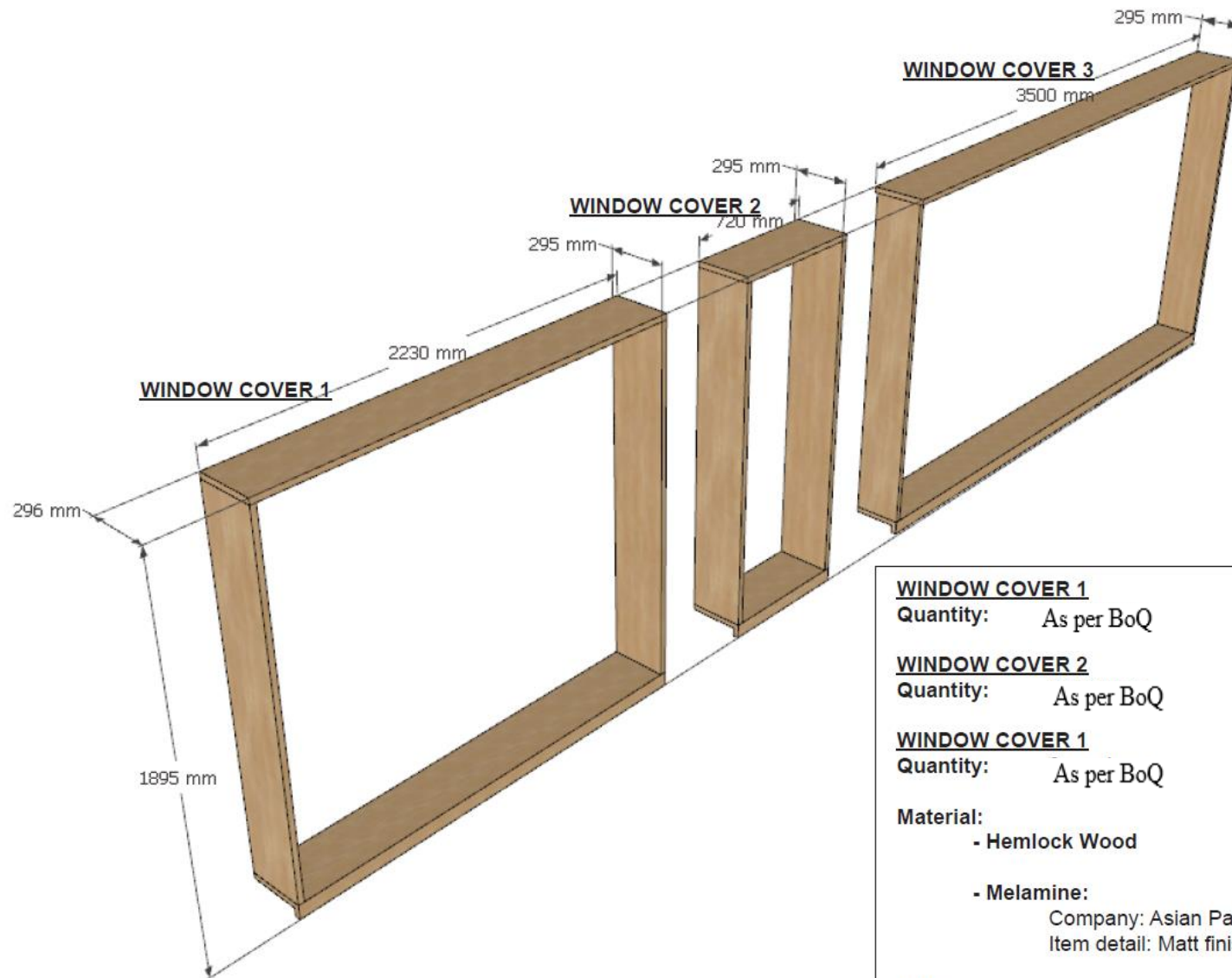

WINDOW COVER 1

Quantity: As per BoQ

WINDOW COVER 2

Quantity: As per BoQ

WINDOW COVER 1

Quantity: As per BoQ

Material:

- Hemlock Wood

- Melamine:

Company: Asian Paints / Nerolac / Woodver
Item detail: Matt finish

Note:

-Size might change depending on site condition

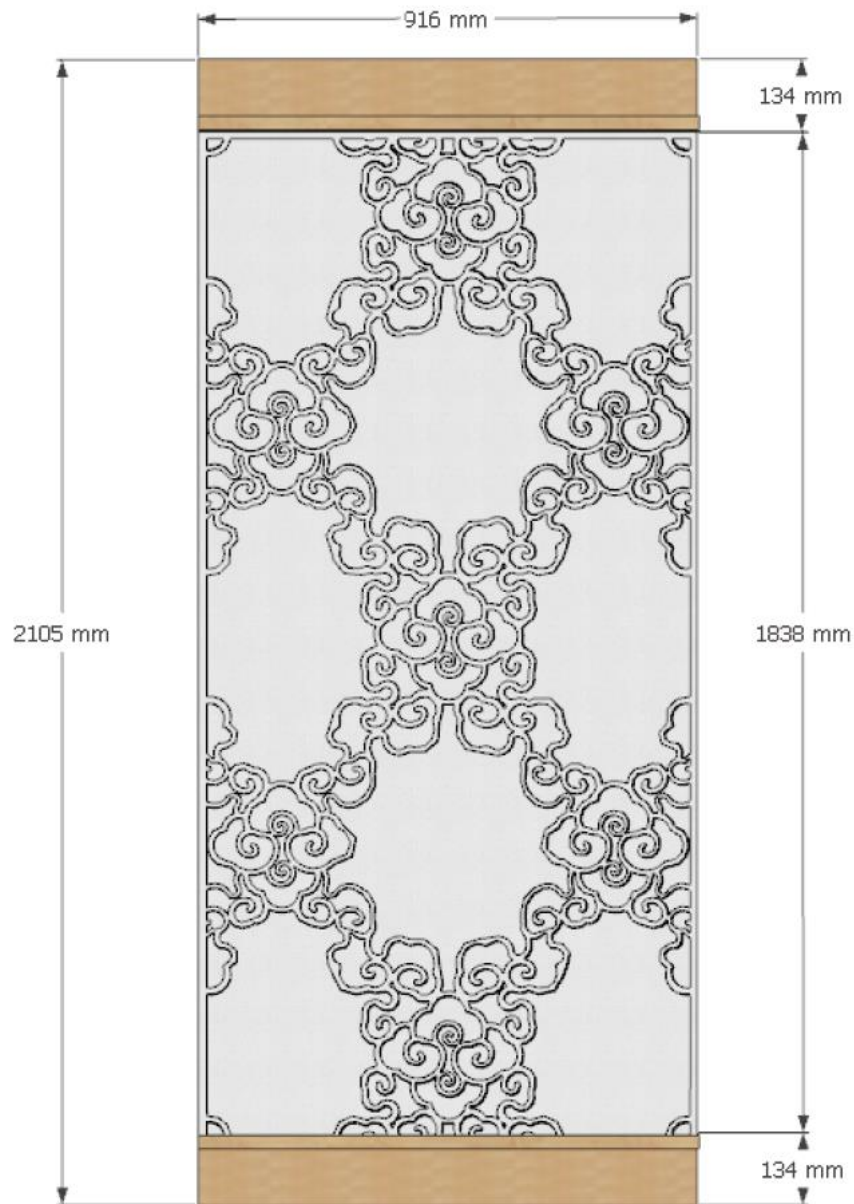

ENGRAVED PIECES

Quantity: As per BoQ

Material:

- Acoustic foam:

Company: TAP Panels or equivalent
Item detail: Light Beige
(engraved)

- Hemlock Wood

- Melamine:

Company: Asian Paints /
Nerolac / Woodver
Item detail: Matt finish

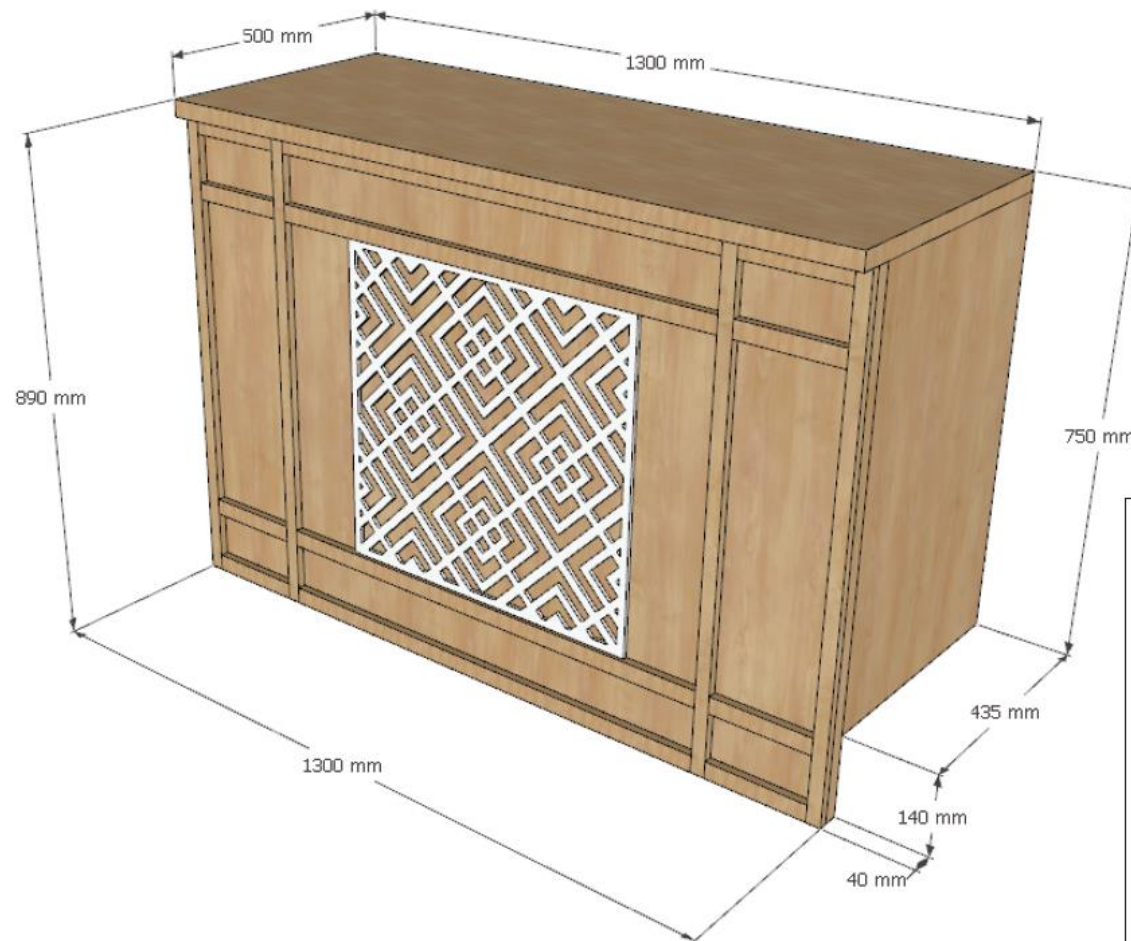

ENGRAVED PIECES

Quantity: As per BoQ

Material:

- 8mm MDF

- Hemlock Wood

- Melamine:

Company: Asian Paints /
Nerolac / Woodver
Item detail: Matt finish

- PU Paint:

Company: Asian Paints/
Woodver
Item detail: White, Matt finish

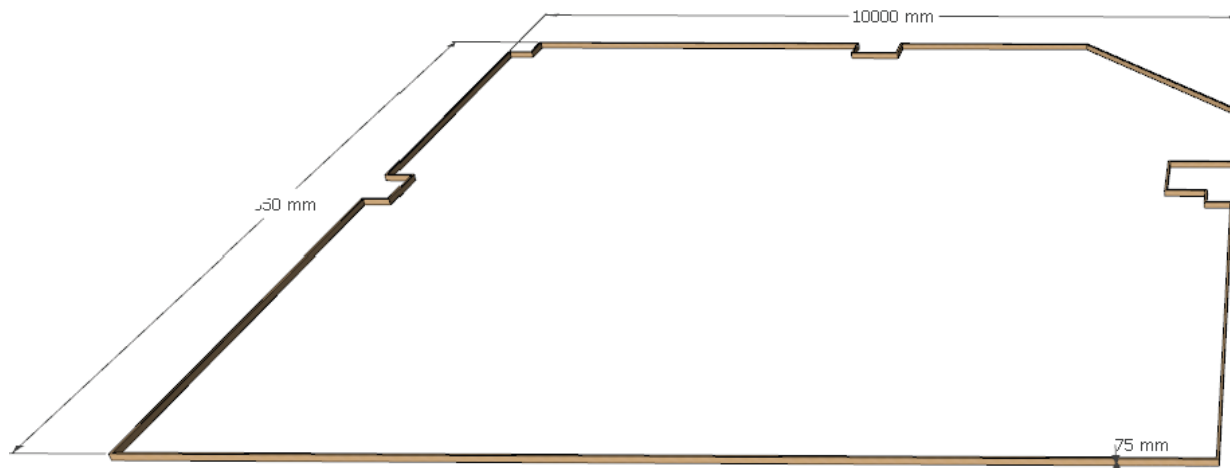

CEILING SKIRTING

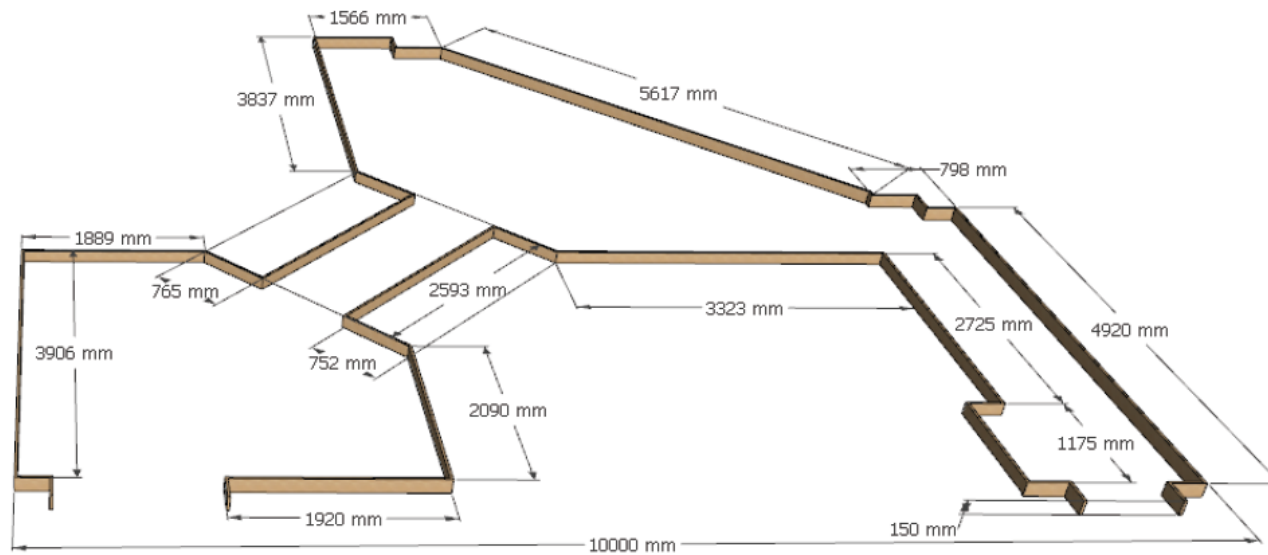

FLOOR SKIRTING

SKIRTING

Quantity: As per BoQ

Material:

- Hemlock Wood

- Melamine:

Company: Asian Paints /

Nerolac /

Woodver

Item detail: Matt finish

-LED Light with profile:

Company: Speed

Item detail: 12w

-LED Light driver:

Company: Speed

Item detail: 5Amp

-Length might change depending on site condition

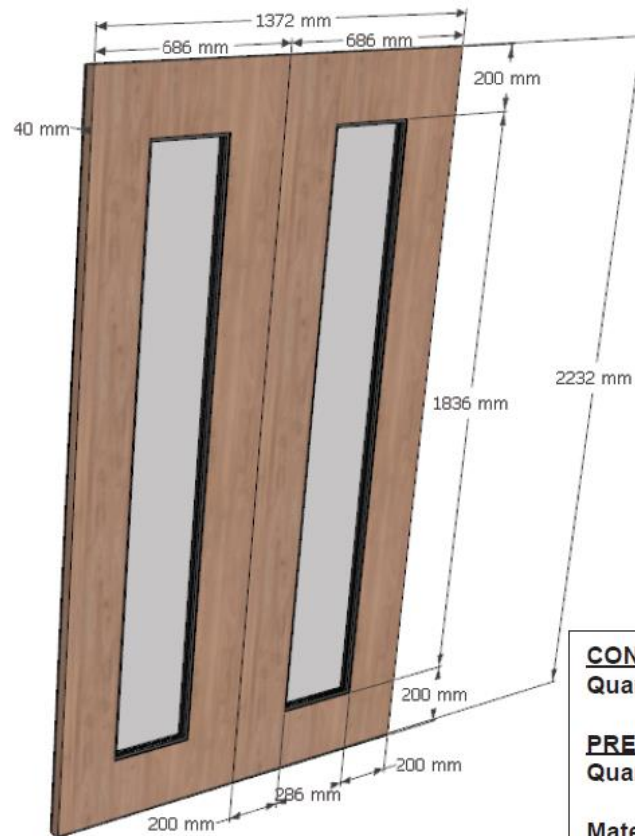
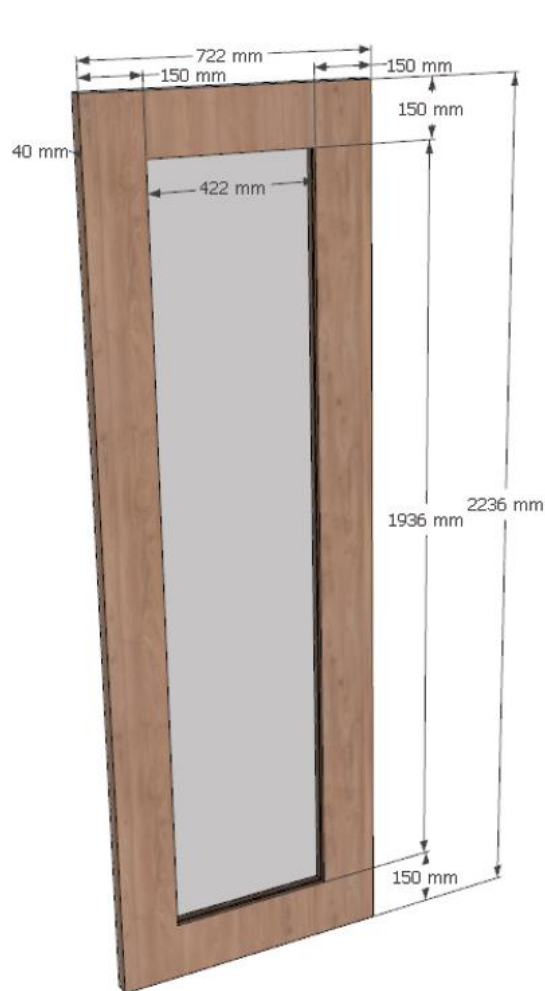

CONFERENCE ROOM DOOR

Quantity: As per BoQ

PRE-FUNCTION ROOM DOOR

Quantity: 1 number

Material:

- Hemlock Wood

- Stain:

Company: Charm wood or equivalent
Item detail: Walnut in Matt finish

- 8mm Glass

Note:

-Length might change depending on site condition



CONFERENCE ROOM WALL (SIDE 1)

Quantity: As per BoQ

Material:

- 12mm Ply

- Hemlock Wood

- Melamine:

Company: Asian Paints / Nerolac / Woodver
Item detail: Matt finish

-Veneer:

Company: Canvas Ply or equivalent
Item detail: White Oak

Note:

-Length might change depending on site condition

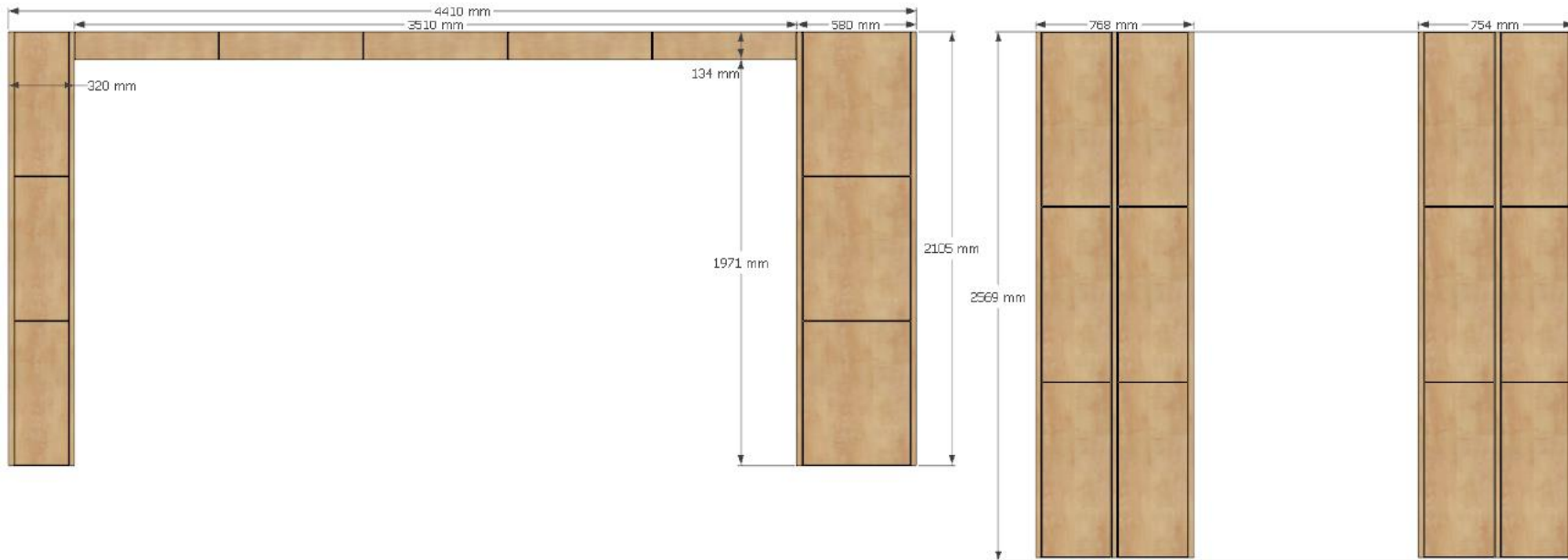

CONFERENCE ROOM WALL (SIDE 1)

Quantity: As per BoQ

Material:

- 12mm Ply

- Hemlock Wood

- Melamine:

Company: Asian Paints / Nerolac /Woodver

Item detail: Matt finish

-Veneer:

Company: Canvas Ply or equivalent

Item detail: White Oak

Note:

-Length might change depending on site condition



CONFERENCE ROOM WALL (SIDE 1)

Quantity: As per BoQ

Material:

- 12mm Ply

- Hemlock Wood

- Melamine:

Company: Asian Paints / Nerolac /Woodver

Item detail: Matt finish

-Veneer:

Company: Canvas Ply or equivalent

Item detail: White Oak

Note:

-Length might change depending on site condition



MDF BANNER

Quantity: As per BoQ

Material:

- 12mm / 8mm MDF

- Stain:

Company: Charm wood or equivalent
Item detail: Walnut in Matt finish

- Hemlock Wood

Note:

-Engraved with Bhutanese motifs. Length might change depending on site condition.

7. Civil works

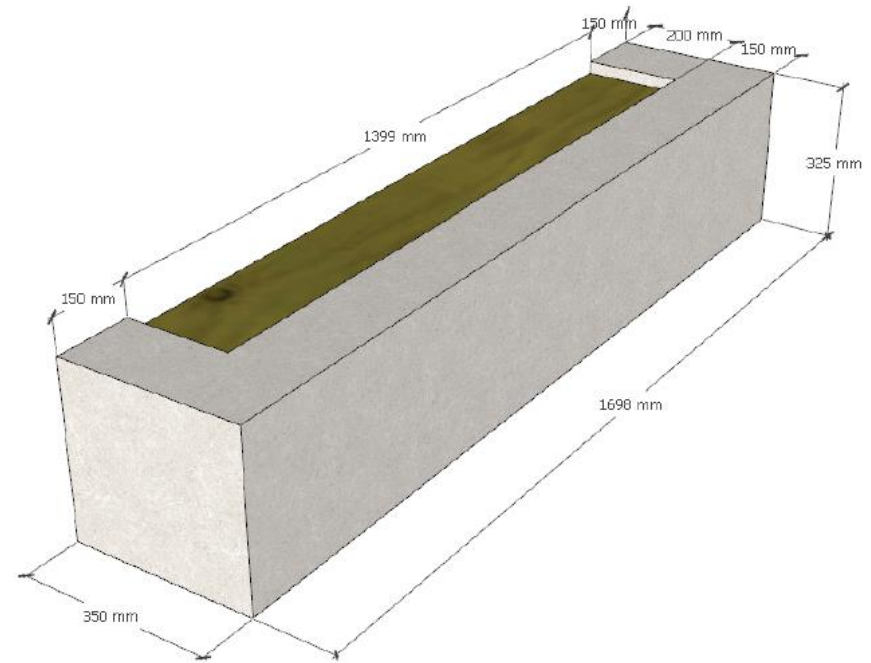
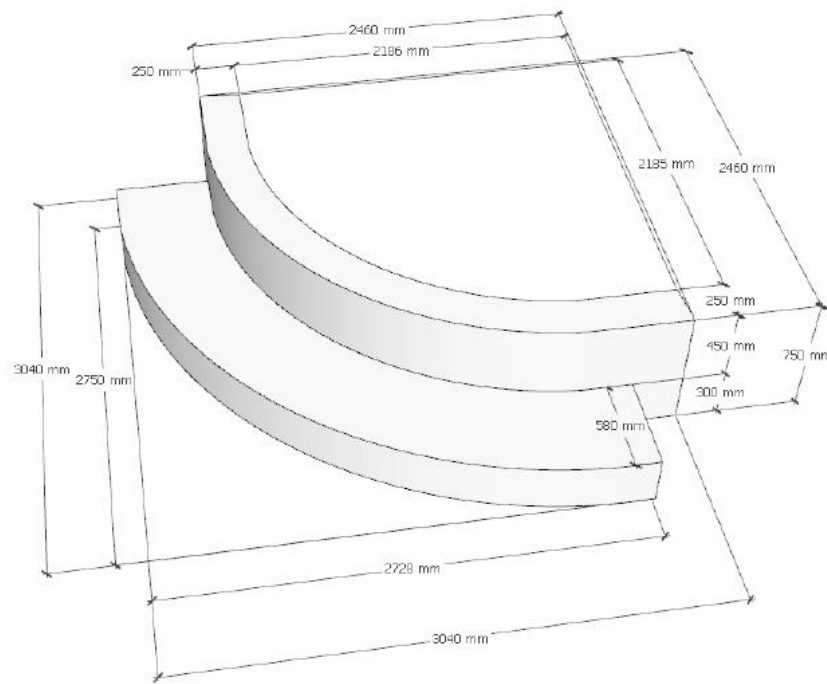

LOBBY CURVED WALL AND LOW WALL PLANTER

Quantity: As per BoQ

Material: - Bricks
- Plaster/ mortar

Product specification:

- Paint:

Company: or equivalent

Item detail: Rangoli White

8. Creche Flooring works



VINYL FLOORING

Quantity: As per BoQ

Company: ArmstrongFlooring™ or equivalent

Product specification: *Rosemary (H3014) & Smokey Jade (H3013)*

DETAILS : PVC, plasticizers, ortho-phthalates, halogens, & isocyanates free.
No polish and low-maintenance solution made with cultured diamonds that offers category-leading scratch, stain, scuff & slip resistance

Size : 6.56 ft. x up to 75.46 ft. x 0.080 in.
2 m x up to 23 m x 2 mm

9. Creche Wallpaper & Panel (Décor) works



WALL PAPER

Quantity: As per BoQ

Company: Marshalls or equivalent

Product specification: *Star wallpaper*

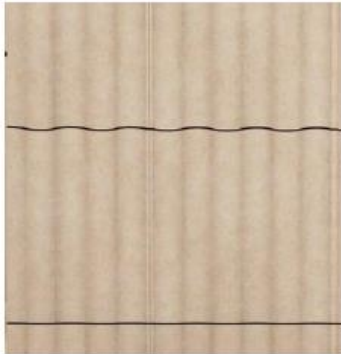

WALL ACOUSTIC PANEL:

Quantity: As per BoQ

Company: TAP Panels or equivalent

Product specification: Various colors

Product Description:

- Size: 600x600 and 8ft x 4ft
- Thickness: 9mm
- Composition: 100% Polyester Fiber (PET)
- Includes all attachments and installation components



PRINTED ACOUSTIC WALL PANEL:

Quantity: As per BoQ

Company: TAP Panels or equivalent

Product Description:

- Size: 8ft x 4ft
- Thickness: Various
- Composition: 100% Polyester Fiber (PET)
- Printed area: 271ft²

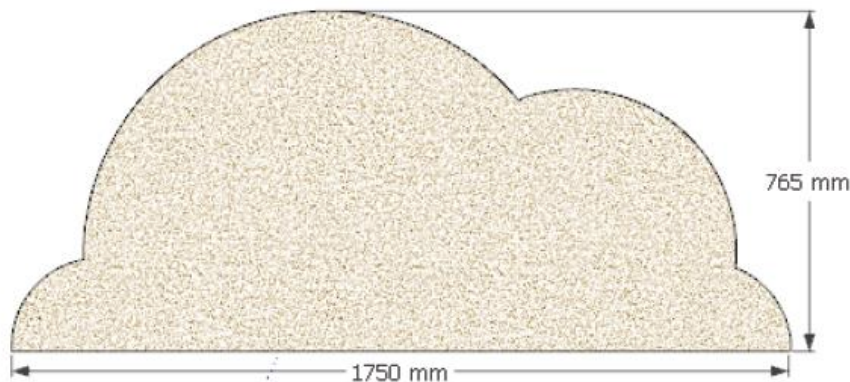

CLOUD DESIGN:

Quantity: As per BoQ

Company: TAP Panels or equivalent

Product Description:

- Size: 1750 x 765mm
- Thickness: 9mm
- Color: Light Beige
- Composition: 100% Polyester Fiber (PET)
- Includes all attachments and installation components

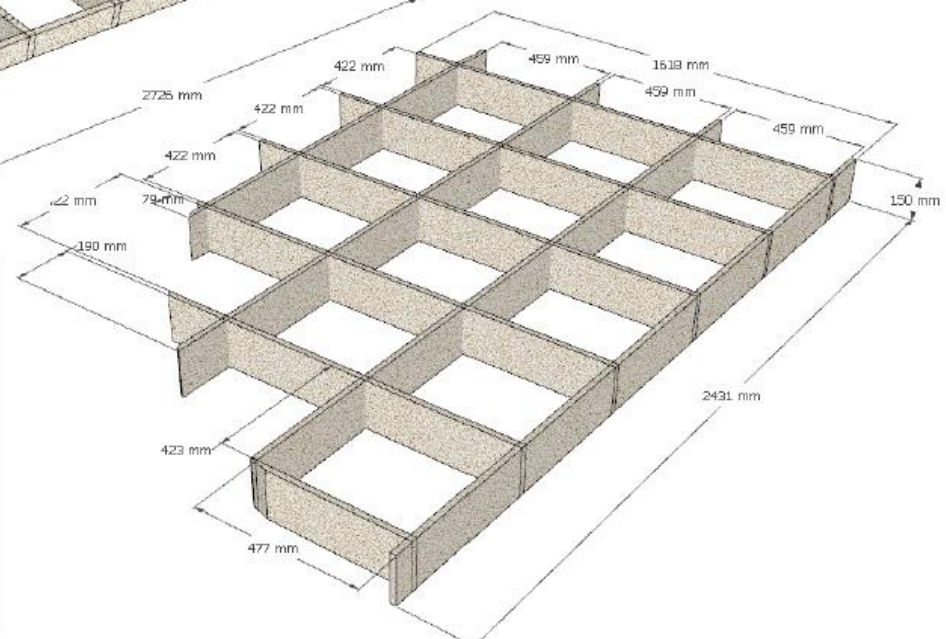
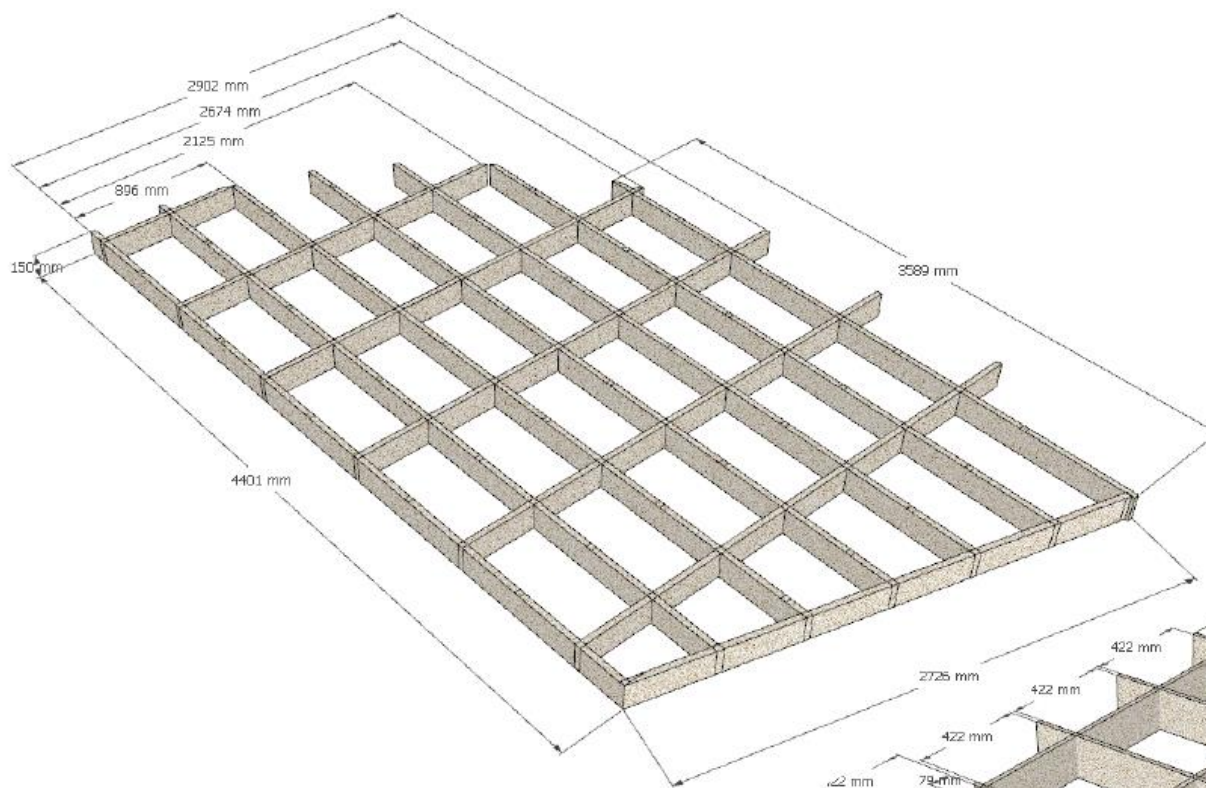

BAFFLE CEILING DESIGN:

Quantity: As per BoQ

Company: TAP Panels or equivalent

Product Description:

- Size: 8ft x 150mm
- Thickness: 18mm
- Color: Light Beige
- Composition: 100% Polyester Fiber (PET)
- Includes all attachments and installation components

10. Creche Light works

LED strip light with profile (m)



Driver for LED lights



11. Creche Sign Board works

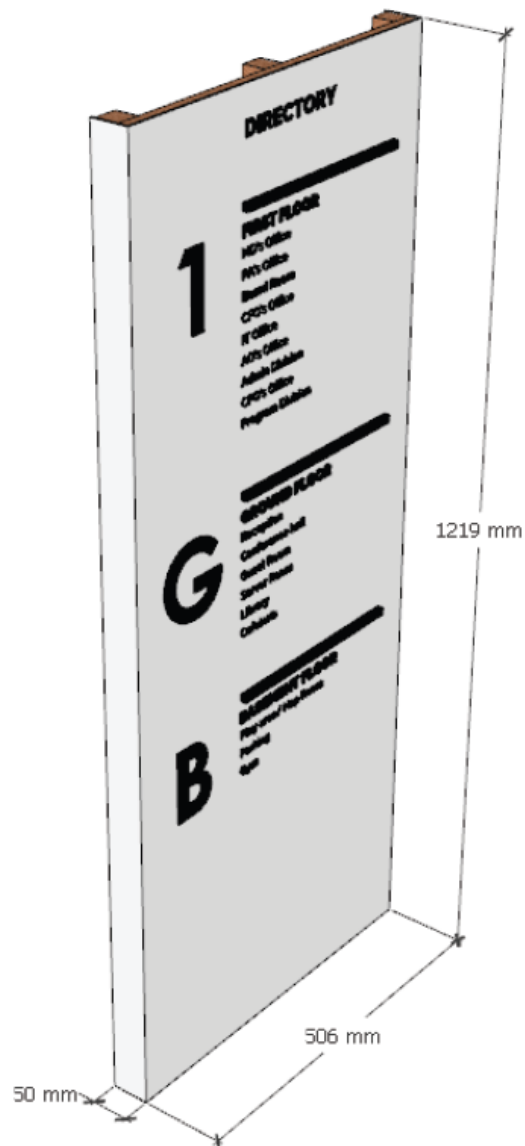

CORNER SIGN

Quantity: As per BoQ

Material: - 12mm Ply backing
- Wooden backing support
(Hemlock)
- ACP

Product specification:

-ACP

Company: Pratap Bond or equivalent

Item detail: PB 18 (Pure White)

Note:

-All text must be finalized before printing.

-Black UV print

12. Creche Furniture works

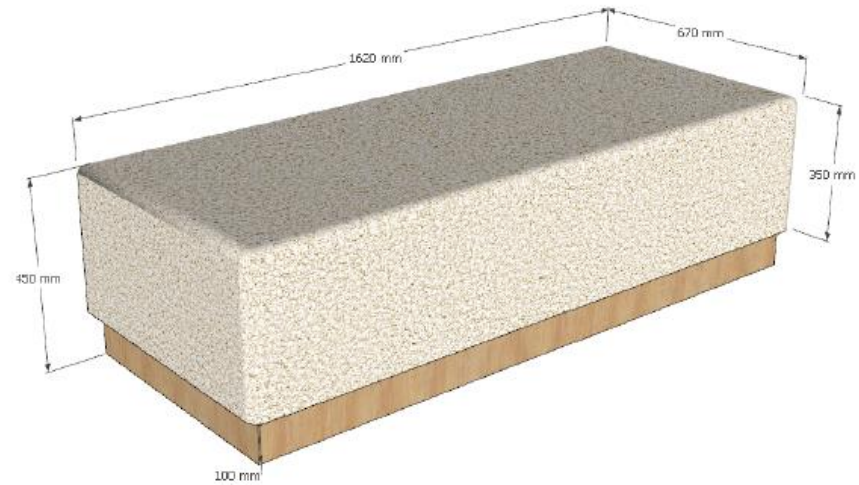
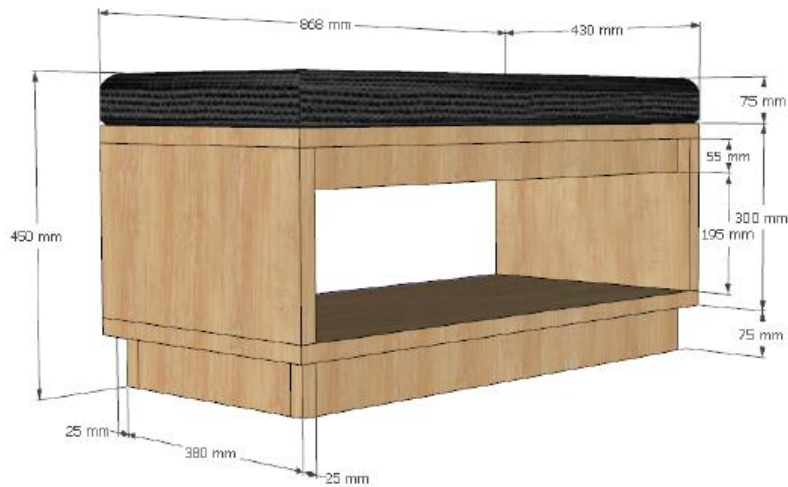

WOODEN BENCH

Quantity: As per BoQ

Materials:

- 12mm Ply

- Hemlock wood

- Melamine:

Company: Asian Paints / Nerolac / Woodver
Item detail: Matt finish

- Foam:

- Company: Bindal
- Item detail: 32 and 23 densities

- Fabric:

- Company: V & J Furnishing or equivalent
- Item detail: Collection: Lampas



PLUSH DEEWANS

Quantity: As per BoQ

Materials:

- 12mm Ply

- Hemlock wood

- Melamine:

Company: Asian Paints / Nerolac / Woodver
Item detail: Matt finish

- Foam:

- Company: Bindal
- Item detail: 32 and 23 densities

- Fabric:

- Company: V & J Furnishing or equivalent
- Item detail: Collection: Brizzo



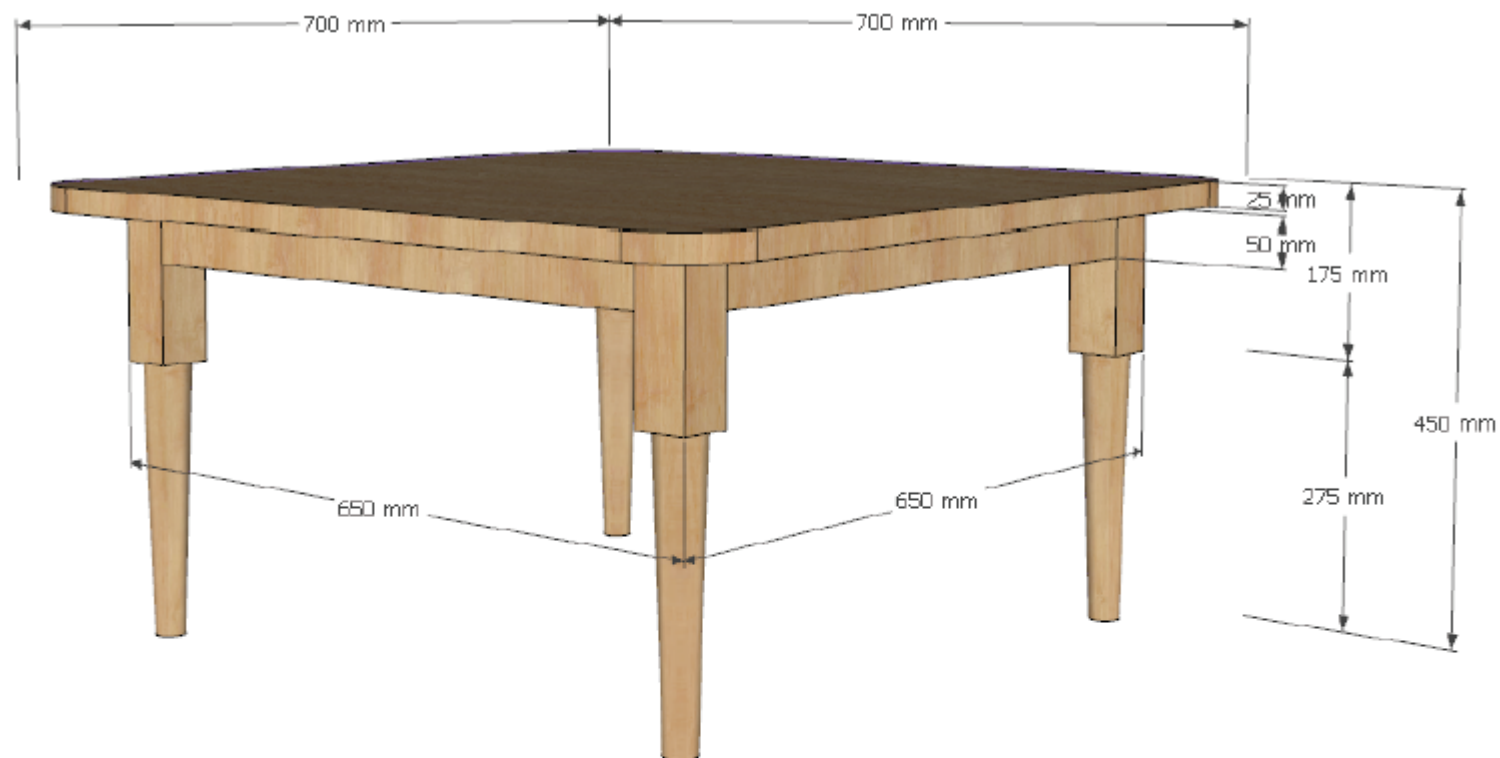

ROUND EDGE TABLE

Quantity: As per BoQ

Materials:

- Hemlock wood

- Melamine:

Company: Asian Paints / Nerolac / Woodver

Item detail: Matt finish

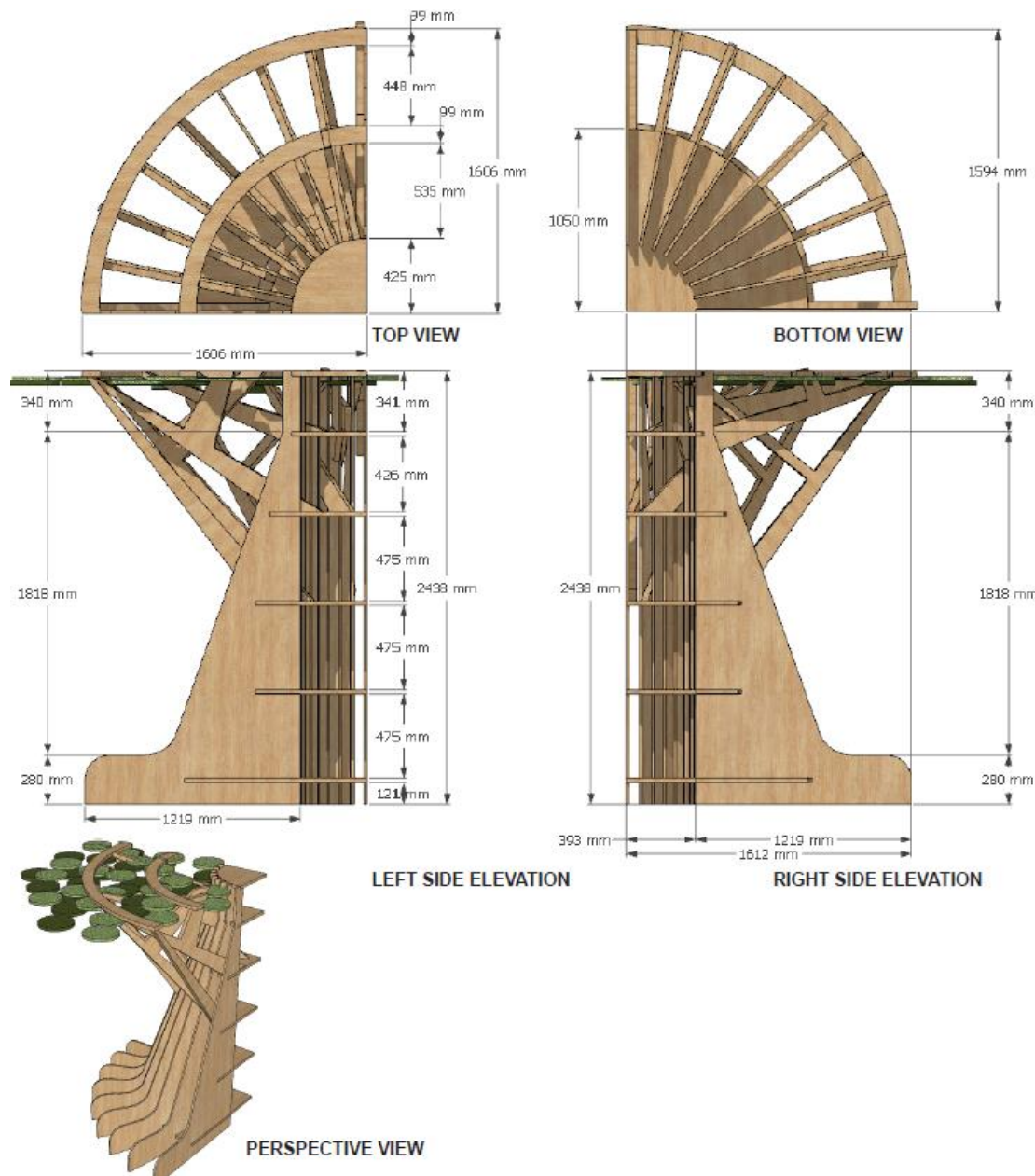

WOODEN TREE:

Quantity: As per BoQ

Company: TAP Panels or equivalent
- (Acoustic panel leaf clusters)

Product Description:

- Size: 300mm diameter
- Thickness: 9mm
- Color: Various
- Composition: 100% Polyester Fiber (PET)
- 43 Pieces per tree

Materials:

- 24mm Rubber-wood CNC'd

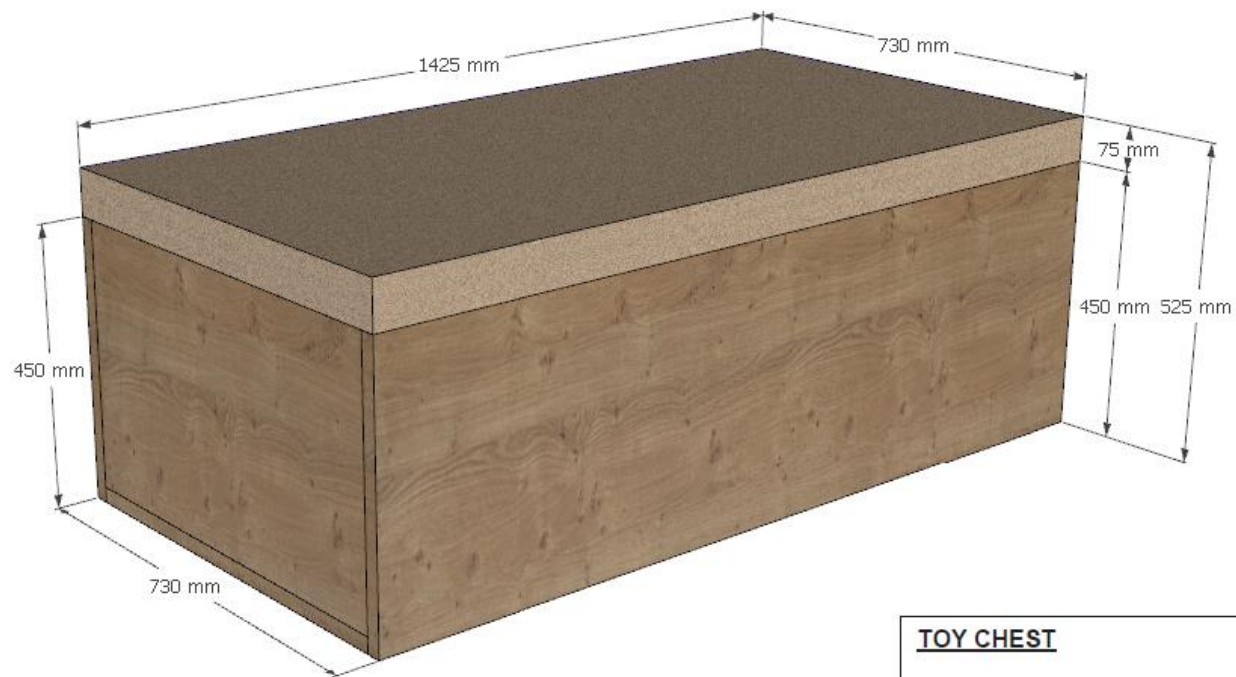

TOY CHEST

Quantity: As per BoQ

Materials:

- 12mm Ply

- Hemlock wood

- Melamine:

Company: Asian Paints / Nerolac / Woodver
Item detail: Matt finish

- Foam:

- Company: Bindal
- Item detail: 32 density

- Fabric:

- Company: V & J Furnishing or equivalent
- Item detail: Collection: Curve

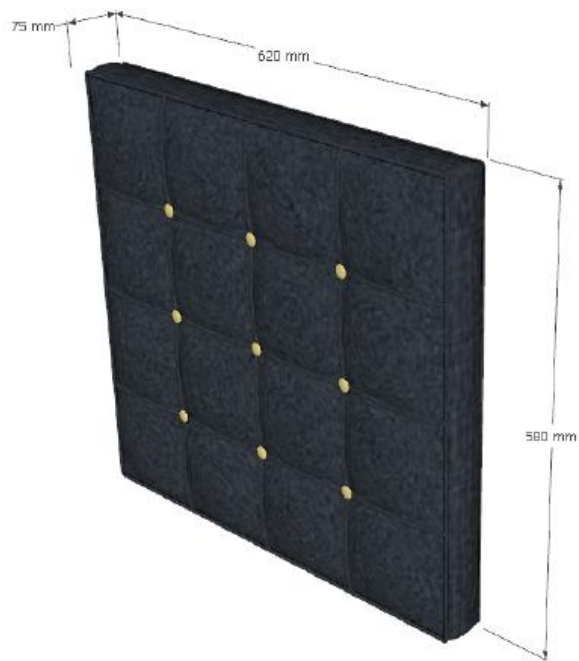

CUSHIONED WALL

Quantity: As per BoQ

Materials:

- Ply

- Foam:

- Company: Bindal
- Item detail: 32 density

- Fabric:

- Company: V & J Furnishing
- Item detail: Collection: Canvas

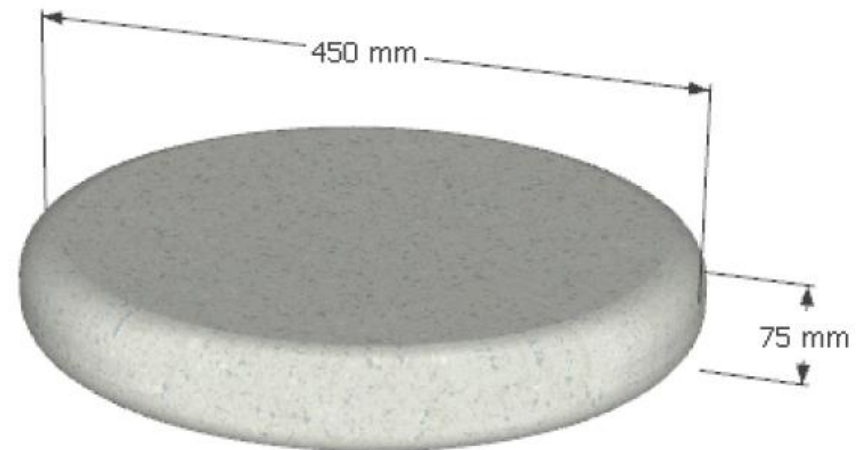

CUSHIONED WALL

Quantity: As per BoQ

Materials:

- Ply

- Foam:

- Company: Bindal
- Item detail: 32 density

- Fabric:

- Company: V & J Furnishing
- Item detail: Collection: Lampas